

NISSAN
FORKLIFT

by **UNICARRIERS**

Platinum Series

RPX Walkie/Rider Pallet Truck
6,000 and 8,000 Lbs. Capacities

WPX Walkie Pallet Truck
6,000 and 8,000 Lbs. Capacities



NISSAN FORKLIFT

by **UNICARRIERS**[®]

For more than half a century, and throughout the world, Nissan Forklift brand material handling equipment has delivered unmatched performance, reliability and value. Featuring unsurpassed quality, and supported by a global parts & service network, our model line-up is designed not just to move your products, but move your entire operation forward.



Up Your UpTime

Reliability is key and that is no mistake. Design, engineering and relentless testing are part of our DNA. The result is what we expect and what you will experience.



Built To Last

Our trucks are “over-engineered” with rugged construction designed to work in the harshest environments, take years of punishment, and keep coming back for more.



Control Freak

When you match our superior maneuverability and vehicle control with greater operator comfort, the result is increased productivity and profitability.



Sweet Savings

Our low cost of ownership is an advantage you can take to the bank. We take our commitment to delivering value seriously because we know you do.

Up and down crowded aisles, in and out of coolers & freezers, hustling to and from the loading dock, stopping and starting, but always on the go, our Platinum Series Pallet Trucks are engineered to offer unmatched reliability and performance.

No other pallet truck is so completely designed to withstand years of day-in and day-out operation, while delivering remarkably low ownership costs. But that's only the beginning: superior maneuverability, maximum operator comfort, servicing ease, and rugged construction are all combined in our pallet trucks.



As you look through this brochure, check out the symbols above for features and advantages available only on Nissan Forklift brand pallet trucks.



Make It Your Own

Choose from a variety of options to customize your truck and maximize its potential, including **Coast Control** and our **Sidetracker** features that make order picking easier.



WPX

When it's better to walk than ride, we've got you covered with the WPX Walkie Pallet Truck — check out its unbeatable package of productivity and profitability features.



To learn more, and find a dealer near you, visit UniCarriersAmericas.com



Up Your UpTime

Your operation can't shut down or slow down because of the equipment you use. That's why our pallet trucks are designed to deliver maximum uptime. From the tips of the forks to the switches on the handle, our trucks are engineered to do more, withstand more, and deliver more, every day.

Unlike competitive equipment, our standard pallet trucks can operate in all environments, moving swiftly and reliably from coolers and freezers down to -20°F (-28.9°C) to dry ambient environments. The temperatures in your operation may vary, but the quality and reliability of our pallet trucks never do.



Wet, Dry, Hot Or Cold Our Sealed Systems Can Do It All



With the RPX, one truck *can* do it all — moving from coolers and freezers to dry ambient environments where condensation will attack. As a safeguard, all of our pallet trucks are equipped with sealed switches, thermal cut-back and shut down, an epoxy coated control board, IP65 rated sealed controller, and sealed steer race — all housed within our rugged frame that's protected by a durable powder coat paint finish. Add in our other standard features like AC motor control and onboard diagnostics, and you have a versatile machine that features infinitely variable travel speeds, multiple plugging, and precise stops for greater efficiency.



To learn more, and find a dealer near you, visit UniCarriersAmericas.com



Our AC Motor That Does More For Less

Greater torque and faster speeds are only the beginning of what our proven 5.2 HP brushless AC drive motor delivers. This 24V system features enhanced thermal capabilities and delivers consistent power during normal battery discharge, while using less energy per cycle. The result? Consistent performance shift after shift, with longer run times between charging.

Since easier maintenance is a key to greater reliability, our high-performance AC Motor is mounted vertically for better heat dissipation and ease of service.



Our Controller Area Network (CAN) System Is Simply Smarter

This innovative design allows digital communication between all operational controls on the steer handle to the truck's controller, allowing multiple signals to travel through the same wire. Plus, every minute the truck is on, it's self-monitoring to assure reliability.

Compare our design to that of our competitors. While competitive systems feature large, bulky connectors which house a web of complex wiring, our exclusive CAN System uses **just four wires** (data in/out and power in/out) in the controller head. The result? A greatly simplified system with enhanced dependability.



Protection of Key Components

Unique steer race and enclosed frame design help keep major components — including drive motor, controller and hydraulic system — free from debris kick-up by the drive tire, resulting in less maintenance and longer life.



Simplified Maintenance Throughout

By making maintenance points more accessible, we cut the time and effort required to keep our machines and your operation moving. Consider this: every grease fitting is accessible from the top side of the truck, so no lifting is necessary.

You'll find common sense design features like this throughout our trucks — but not on our competitors.



Built To Last

Packed trailers, extensive shuttle runs, heavy loads, long days. You have to be tough to work in that kind of environment, and Nissan Forklift by UniCarriers Pallet Trucks are built to not only withstand these conditions, but thrive in them. It's not just the rugged steel construction, but the innovative designs throughout our trucks that shield both machine and man from abuse.

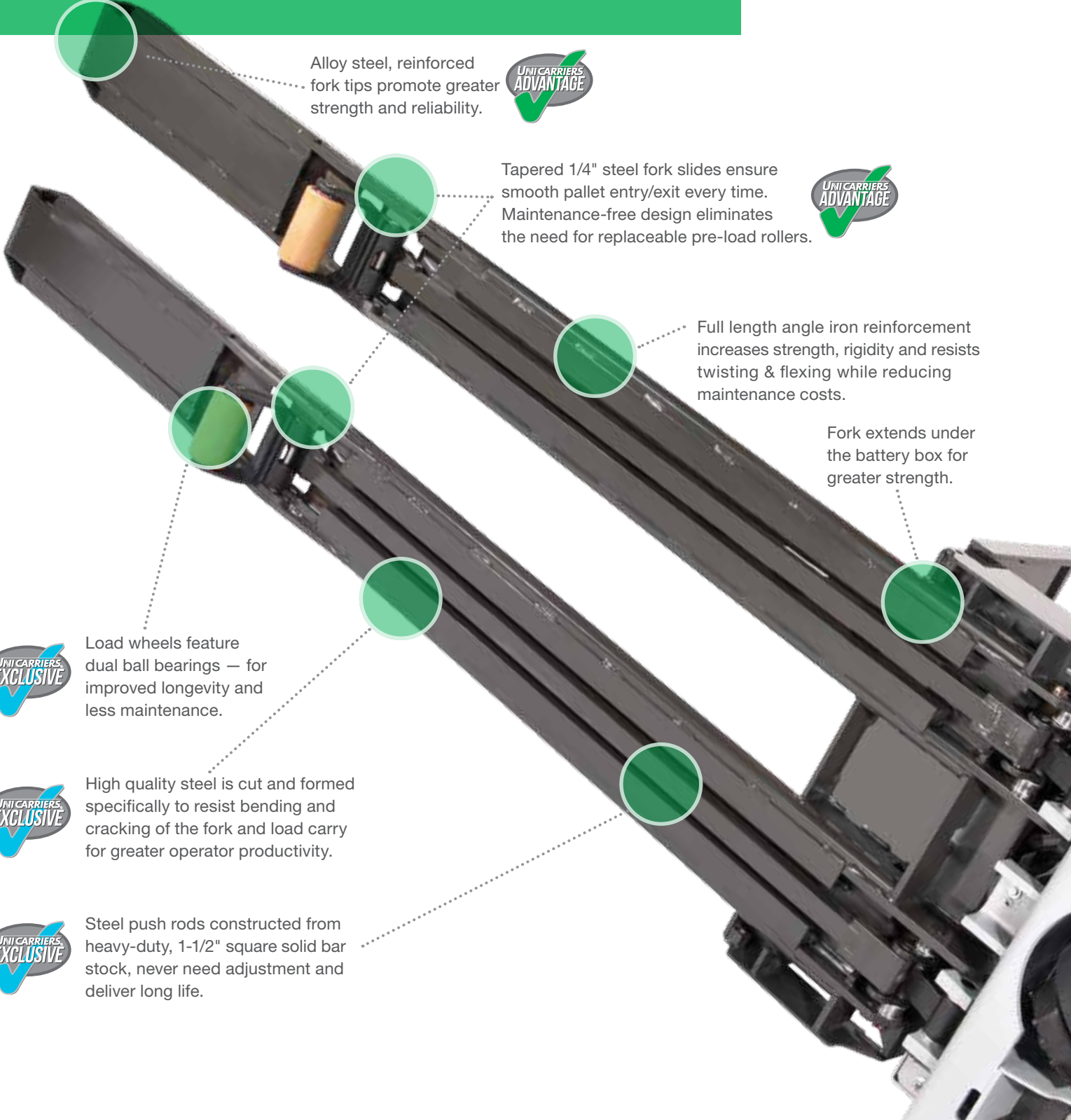

Alloy steel, reinforced fork tips promote greater strength and reliability.



Tapered 1/4" steel fork slides ensure smooth pallet entry/exit every time. Maintenance-free design eliminates the need for replaceable pre-load rollers.



Full length angle iron reinforcement increases strength, rigidity and resists twisting & flexing while reducing maintenance costs.

Fork extends under the battery box for greater strength.



Load wheels feature dual ball bearings — for improved longevity and less maintenance.



High quality steel is cut and formed specifically to resist bending and cracking of the fork and load carry for greater operator productivity.



Steel push rods constructed from heavy-duty, 1-1/2" square solid bar stock, never need adjustment and deliver long life.

Rise Above Costly Damage

Take control using the Auto-Lift feature to ensure forks are automatically at their maximum lift height during operation. Optional feature provides ample clearance over dock plates or uneven floors, reducing the chance of pallet damage or replacement of costly load carry components.

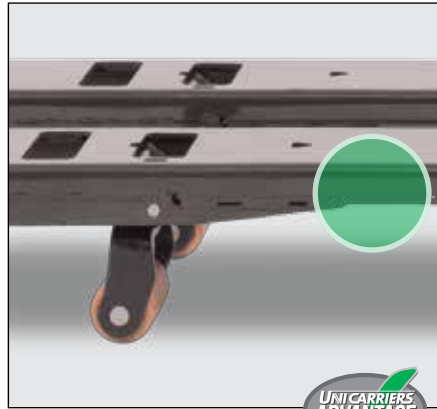

Protects Your Truck Protects Your Budget

With our push design lift linkage, the solid steel tie rods never extend beyond the plane of the fork, but move down the middle, improving ground clearance, preventing possible damage, and reducing maintenance costs. In competing systems, the tie rods extend beyond the forks, exposing them to costly damage, especially while driving over dock plates.



No Bends, No Dents No Rust, No Problem

The hood and cover on our pallet trucks are made of rugged polycarbonate that won't bend, dent, fade or rust, while the entire frame (including the load carry) is powder coated inside and out, for even greater durability.

Keeps Your Business Rolling

Heavy duty, yet simple caster design incorporates single-point height adjustment and an angled side bracket to prevent dock plate hang-ups. Accessible grease fittings on swivel and axle help promote routine maintenance.

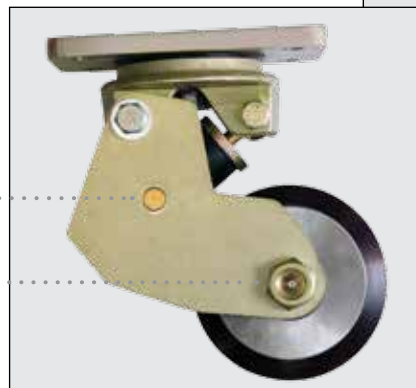
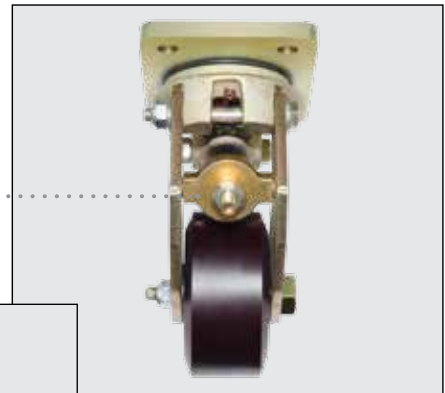

To learn more, and find a dealer near you, visit UniCarriersAmericas.com



Control Freak

Whether it's navigating tight aisles, handling heavy, uneven loads, picking multiple orders, or traveling to and from the dock, Nissan Forklift by UniCarriers Pallet Trucks put you and your operators in control. From the ergonomic design of the steerhead to the size and comfort of the platform, our trucks have been engineered to put your operators in comfortable command of any situation.

Steel reinforced fiberglass-filled polymer construction is virtually unbreakable.



Maintenance-free electronic horn design eliminates rust due to condensation for longer economic life.



Large safety reversing button changes truck direction if contact is made.



Requiring significantly less effort versus twist grip controls, our fingertip design reduces operator fatigue and allows precise travel speed control.



Sealed switches require no heaters or thermostats, are designed for a minimum of 5,000,000 actuations, and can operate in coolers, freezers and wet rooms at temperatures as low as -20°F (-28.9°C).

Optional Sidetracker controls are strategically placed within easy reach for assured control of the truck when walking beside it — available with our Coast Control feature.



Coast Through Your Picking Operations

To improve picking efficiency, our optional Coast Control offers electronic activation with our Click-n-Coast feature or select a manual toggle lever. Optional coast features include two Sidetracker switches, conveniently located inside the handle, for more precise control and greater flexibility.



A Turn For The Better

To navigate even the tightest of spaces, our pallet trucks offer you a full 190° steering range.



Putting The Brakes On High Costs

Our Smart Electric Brake uses regenerative motor torque prior to brake actuation. It features fewer parts, never needs adjustment, and extends component life.



Greater Operating Range

The light, spring-loaded design of our steer handle requires less effort while letting your operators find the ideal operating position.



Step Up To A Bigger, Better Platform

For greater comfort, productivity and safety, UniCarriers offers the largest operator platform in the industry. It features a bolt-on design for easy removal and replacement, a softer, anti-fatigue surface, and a rugged 1/2" formed plate steel outer bumper.



To learn more, and find a dealer near you, visit UniCarriersAmericas.com



Get A Grip On Comfort

Our ergonomically designed intermediate, high speed handrail is rubber padded for comfort but features thick tubular steel construction for years of service. The sealed, large, soft-touch buttons put your operator in complete control of fork raise/lower, high speed and horn functions. It's also bolted onto the frame for easy replacement or repair.



A Multi-Function Display For A Multi-Faceted Truck

Our optional multi-function LCD digital display includes PIN codes to restrict truck access, selectable performance modes, battery discharge indicator, multiple hour meters, programmable service reminders, and speedometer. It also offers on-board diagnostics, troubleshooting and multiple speed adjustments.



Sweet Savings

Everyone talks about Lowest of Cost of Ownership, but how do you judge it? We suggest you examine a pallet truck in four key areas: Reliability, Durability, Performance Features, and Operator Comfort/Productivity.

When you look at these essential elements of value, you'll see that our pallet trucks offer you the most complete package of time, effort and money-saving features available.

This value begins by offering you one truck for all environments and applications. Thanks to our unique design that includes sealed switches and logic boards, our pallet trucks can work in a wide range of operating environments, going from ambient temperatures to coolers, wet rooms, or freezers down to -20°F (-28.9°C).

But that's only the beginning.

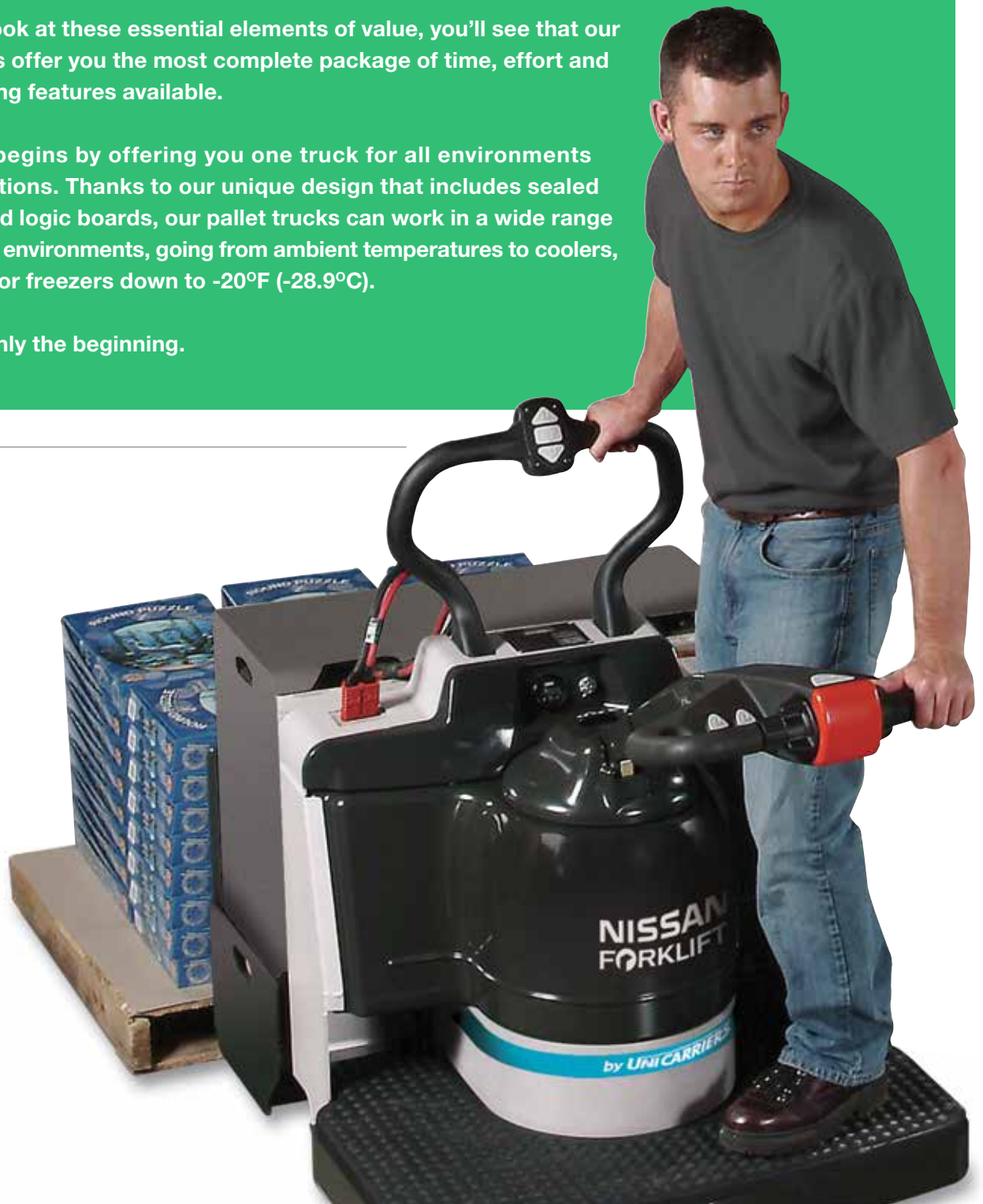

Check out all the RPX offers you...

More uptime, all the time.

- Controller Area Network (CAN) System allows digital communication between the control handle and controller through only four wires for multiple signal transfers, greater reliability and easier maintenance
- Sealed switches are used for longer life, rated to a minimum 5,000,000 actuations, and require no heaters or thermostats
- Sealed controller has an IP65 rating and features thermal protection
- Push lift linkage does not extend beyond the plane of the fork helping to prevent damage
- Smart Electric Brake uses regenerative motor torque prior to brake actuation that extends brake life
- 5.2 HP heavy duty, three-phase brushless AC motor features enhanced thermal capabilities
- Hall Effect speed & direction control simplifies maintenance and limits downtime — no heaters or potentiometers, fewer moving parts
- Optional Auto-Lift helps prevent forks and linkages from being damaged in loading and unloading applications

Durability down your aisles and down the road.

- Powder Coat paint inside & out creates a scratch-resistant, durable finish
- Rugged polycarbonate hood and covers won't bend, dent or rust
- Heavy plate steel frame design is built to absorb and withstand impacts
- Operator platform features a rugged ½" steel outer bumper
- Fork assembly formed from ¼" plate steel
- Full-length angle iron reinforcement on forks increases strength, rigidity and assembly life, while resisting twisting and flexing
- Forks extend under the battery box for greater strength and rigidity

- Our unique push lift linkage features solid steel tie rods for exceptional strength and durability
- Steel reinforced steer handle is made of a special, virtually unbreakable fiberglass filled polymer
- Optional stainless steel axles and linkage pins deliver longer life and reduced maintenance
- Tubular steel construction adds greater durability to the intermediate, high speed hand rail

Turning operator comfort into operating excellence.

- Advanced controller system offers smooth, infinitely variable speeds
- AC motor offers high speed/high torque performance
- Wide steerhead includes smart layout of large, soft-touch switches and fingertip directional controls for greater operator comfort
- High speed hand rail reduces operator fatigue, improves grip and stability, and features low-effort switches
- Multi-Functional Digital Indicator features battery discharge, 3 hour meters
- Optional Coast Control is available with our electronic Click-n-Coast or manual actuation to make order picking faster and easier
- Ergonomically actuated Sidetracker enhances our Coast Control making it easier to control the truck while walking beside it
- Optional Tilt-Down Backrest makes battery removal faster and easier — 48", 60" and special sizes available
- Largest operator platform in the industry features an anti-fatigue platform mat
- Alloy steel fork slides facilitate pallet entry/exit and eliminate the need for pre-load rollers
- Steer handle's light, spring-loaded design makes it easier for operators to find their optimal operating position

- 190° steering range assures a tighter turning radius
- Reverse button is extra large for greater operator protection and automatically reverses truck travel if contact is made
- Fingertip control reduces the risk of repetitive motion injury and is gentler on wrists than twist grip controls
- Dual brake positions for greater operator safety

Spend a lot less time and money on service.

- Rugged stability casters include a grease fitting and single point adjustment for reduced maintenance
- Easy hood removal means superior service access to controller, hydraulics, electric brake, drive system and motor
- Smart electric brake system requires no adjustments
- AC drive motor is vertically mounted for easy access and requires only 6 bolts to remove
- Sealed drive motor and controller area keep out dirt and debris
- The electric horn is maintenance-free and will never rust
- Optional LCD meter panel includes on-board diagnostics and troubleshooting
- Platform uses a bolt-on design for easy removal
- Drive wheel, load wheels and casters offer string guards to help prevent debris from getting caught in wheels
- Reinforced fork tip design uses no pre-load rollers and requires no maintenance
- Our unique push lift linkage never needs adjustment
- Hand rail is bolted to the frame for easy replacement or repair
- All grease fittings are accessible without raising the truck off the ground
- No heaters used mean fewer components to maintain

Make It Your Own

While the RPX features the industry's most comprehensive package of standard features, we know that your operation has its own unique set of challenges. That's why you can choose from an array of options to create a truly customized truck for your specific needs.



Auto-Lift

This unique feature automatically raises forks to prevent dragging — a must for driving over dock plates or across sloped or uneven floors.



Coast Control with Sidetracker

This reliable system makes order picking faster and control of the truck easier while walking.



Load Backrests

Slip-on and tilt-down designs are available to make battery removal quicker and simpler. Can also be welded on.



Accessory Pole

Provides a convenient solution to securely attach options including work and strobe lights, operator fan and clipboard.

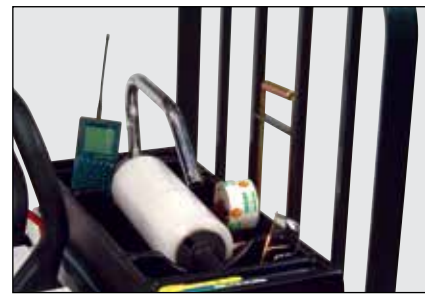

Magnetic Convenience Tray

Handy tray adheres to the top of the battery box and includes a stretch wrap holder and room for tools.



Selection of Drive Tires & Load Wheels

Choose from a variety of options to support your application.



Rust Free Battery Rollers

Roller design made of durable poly material incorporates an anodized metal pin for longer life.



Extended Skirt

This important option provides additional protection for operators' heels. Not recommended for applications where dock plates are present.



Multi-Functional LCD

Includes on-board diagnostics, trouble shooting, selectable performance settings and more.

Fuel Cell Ready

Nissan Forklift by UniCarriers Pallet Trucks can be powered using fuel cell batteries. Contact your battery representative for information on fuel cell technology.



To learn more, and find a dealer near you, visit UniCarriersAmericas.com



WPX Walkie Pallet Truck



When You Don't Need A Ride, The WPX Walkie Pallet Truck Gives You A Lift.

The WPX offers a durable, dependable, and versatile design for a wide range of applications in all kinds of operating environments. From manufacturing to warehousing to grocery, it's the one walkie pallet truck you can count on.

The WPX shares all the performance features of the RPX, including:

- 5.2 HP heavy-duty, three-phase brushless AC drive motor with enhanced thermal capabilities and greater torque
- Sealed switches and logic boards for operation in coolers, wet rooms, and freezers down to -20°F (-28.9°C)
- Exclusive Controller Area Network (CAN) system uses just four wires to send multiple signals between the control handle and controller
- Rugged construction, including tubular steel steer handle
- Ergonomic features, including large, soft-touch switches
- String guards on all wheels
- Wide array of optional equipment, including Auto-Lift and multi-function LCD meter panel

 To learn more, and find a dealer near you, visit UniCarriersAmericas.com



Built Like No Others.
Backed Like Nothing Else.



Quality, performance, reliability and efficiency — we believe the same attributes that make a great forklift are also essential elements of an exceptional company. As a result we've built an organization that overlooks no detail in manufacturing material handling equipment that delivers the highest levels of **performance and value** — and that stands behind our products with comprehensive service and support.

Our products are designed to produce maximum productivity without compromising operator safety. **They're built to exacting standards to maximize uptime.** They're scrupulously tested to ensure strict tolerances are met — and offered by a network of highly skilled, highly professional dealerships committed to customer satisfaction.

And when it comes to the environment, we put the same passion and energy into creating an effective sustainability initiative as we put into engineering our products.

At UniCarriers, our mission is to continuously move performance standards upward — and to provide the support you need to move your business forward.

SB RPX 10-2014
Printed in U.S.A.



UniCarriers® is a registered trademark of UniCarriers Corporation. UniCarriers Corporation reserves the right to make product changes relating to colors, equipment, specification or available options without notice.

For more information, contact your Nissan Forklift by UniCarriers representative.

UNI CARRIERS®

UniCarriers Americas Corporation

UniCarriersAmericas.com