

NISSAN
FORKLIFT

by **UNI CARRIERS**

Platinum BX Series

Cushion & Pneumatic Tire

Battery Powered Models



3,000 - 5,000 lbs. Capacities
Pneumatic Tire

3,000 - 8,000 lbs. Capacities
Cushion Tire



NISSAN FORKLIFT

by **UNICARRIERS**®



Up Your UpTime

Reliability is key and that is no mistake. Design, engineering and relentless testing are part of our DNA. The result is what we expect and what you demand.



Comfort Zone

Work comes first, but there are amenities that make the experience more pleasurable. And happy drivers are statistically more productive.



Power & Performance

Our 100% AC motor and controller system and intuitive designs allow you to move in a way that makes sense. The resulting productivity saves you time, money and driver mishaps.



Sweet Savings

Our low cost of ownership is something you can take to the bank. We take our commitment to delivering value seriously because we know you do.

For more than 50 years, Nissan Forklift brand equipment has delivered the performance, reliability and value our customers need to move their products and drive productivity.

Designed for efficiency, built for years of enduring service and backed by a network of highly skilled and factory trained professionals, Nissan Forklift is the brand of choice for any organization that wants more out of their equipment and their investment.



Play It Safe

Your employees' well-being is an imperative. Standard protection features mean greater confidence in the workplace.



Control Freak

High productivity operations have more flexibility when unexpected changes occur. Manage your operation using smart designs without slowing down the pace.



Make It Yours

Choose from a variety of options to customize your ride. If you don't see what you need, contact your authorized UniCarriers dealer for help.



Up Your UpTime



Reliable AC technology throughout

The BX Series is powered by our 100% AC motor and controller system, including a hydraulic pump motor to power its steering.

With better cooling capacity and greater reliability even in humid environments, AC power delivers more consistent and higher performance throughout the shift on a single battery charge.

Thermal protection alerts operator of overheating

Thermal sensors help protect the pump and drive motor and controller systems, promoting more reliable performance. A warning will flash on the LCD screen to advise the operator if overheating has occurred, followed by reduced travel and lift operations. Information is automatically locked into the truck's service history to assist the technician.

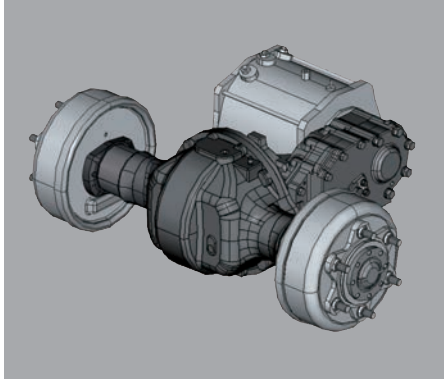

Dependable Drive Units

AC induction drive motor technology means fewer parts to maintain. Paired with a simple, but effective transmission design, the BX delivers dependable performance.

Reduce downtime through self-diagnostics

An integrated self-check provides immediate truck status. Its intuitive dialogue display combined with accessible service history reduce troubleshooting time, so the unit is back in operation faster. Everything is done through a smart LCD panel. No handset device is needed.



Simplified battery maintenance & replacement

Gas stay assist keeps the hood open nearly 90 degrees making routine battery maintenance and change-outs faster. Optional rollout design* further simplifies battery removal.

* Available on most models.



Comfort Zone

Work comes first, but there are amenities that make the experience more pleasurable. And happy drivers are statistically more productive.



High-visibility carriage

Pair this option with the OptiView or any of our triple stage or wide view mast designs for even greater visibility. Available at no additional cost on model capacities up to 5000 lbs.



A productive shift starts with a comfortable seat

Our standard design includes lumbar support adjustment, weight-adjustment plus operator restraint armrests. A non-cinching seat belt offers greater range of movement for the operator, while its full-suspension design means better shock absorption.

Seat and backrest cushions can be individually replaced. Cloth or vinyl available.

Lumbar support adjustment

Weight adjustment



Improved control and safety

Maneuverability during reverse driving is easier with an optional secure assist grip. And it helps keep the operator's hand safely inside the compartment where it belongs. A horn button is included.



Convenience at your fingertips

Standard automotive-style controls are located on either side of the steering column.

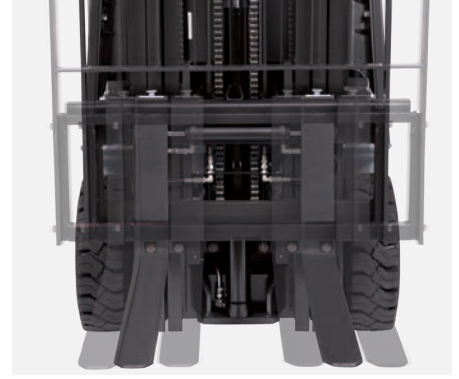

Sideshifting Fork Positioner

Optional feature hydraulically positions forks, eliminating the need for manual adjustment by the operator.



Low profile dashboard

43.5" of headroom

High profile seat position

Wide entry/exit



Power & Performance

Highly responsive, highly productive.

The BX Series' AC power system delivers responsive, precise control for greater productivity throughout the work cycle. Faster acceleration, higher top travel speeds and infinitely variable lift/lower control mean more work is completed, faster.

Customize truck performance for optimum results

Three factory-set performance parameters offer a starting point to simplify customization. Or use the manual mode to create unique settings that are finely tuned to match the application or driver experience.



Economy Mode

Extended operating hours achieved with only slightly reduced performance.



Performance Mode

Offers mid-range settings for normal performance needs.



High Performance Mode

To reach maximum desired performance.



Manual Mode

Provides access to create customized performance parameters.

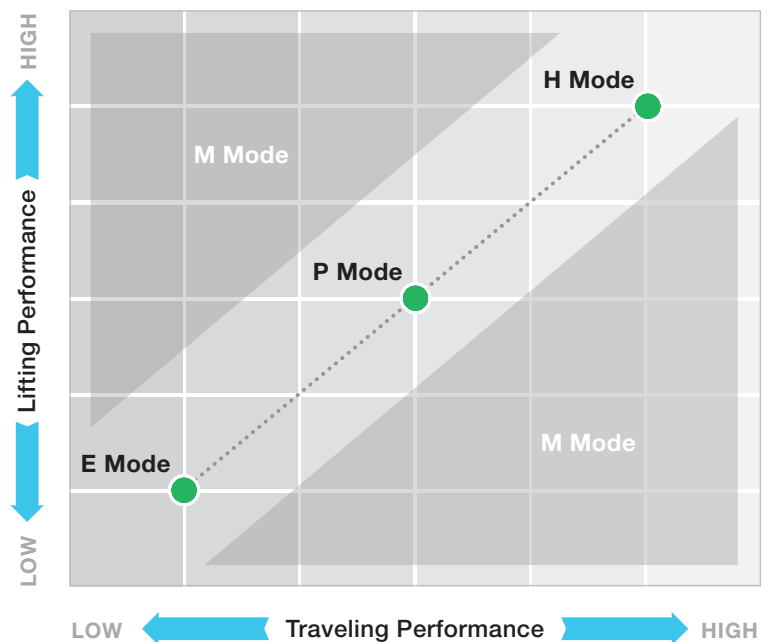

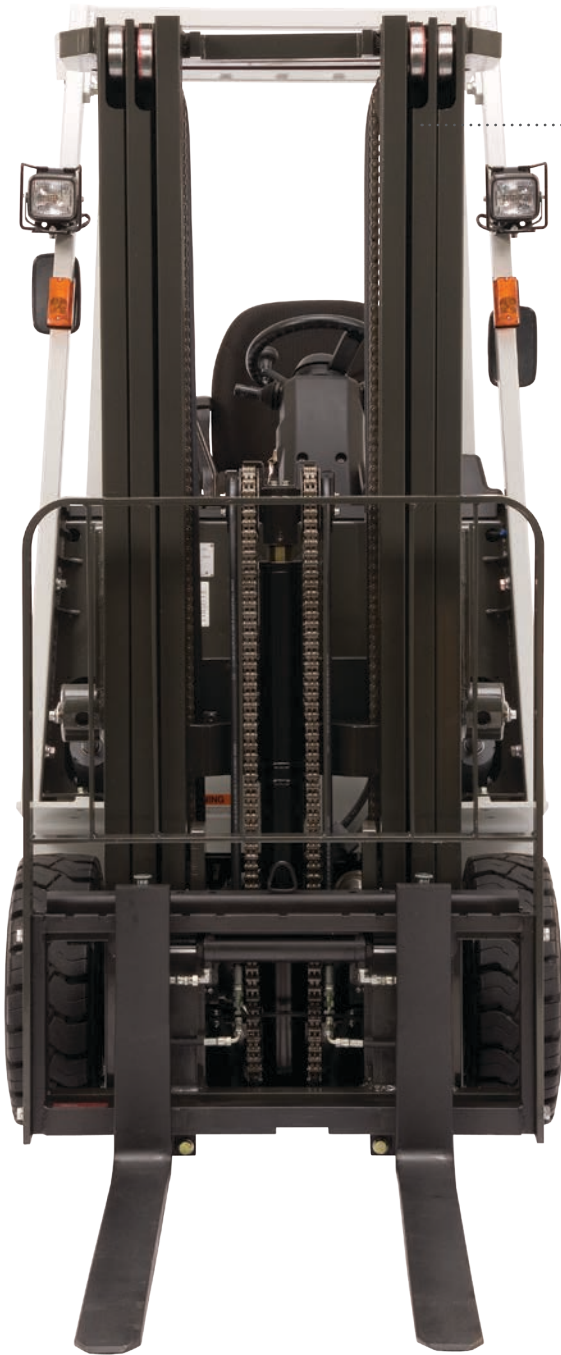

Rugged UCA designed and manufactured mast

Our mast features rolled steel channels and thick inner rails for increased capacity retention. Side thrust rollers on the fork carriage are easily accessed for carriage adjustment.



Tackle the tough jobs with BX pneumatics

In addition to most of the same standard features available on the cushion tire series, pneumatic tire BX trucks have a wider stance and higher under clearance for more rugged applications. Available in eight models, ranging from 3000 to 5000 lbs. lifting capacities. (Includes larger battery compartment models.)

Fast acceleration, travel and lift speeds

Use the high performance setting to reach top speeds and optimize productivity. Program the truck's response time through its Flex-Logic system for quicker acceleration.

Travel Speeds

9.3 / 10.6
MPH

Full load / No load

Lift Speeds

68 / 119
FPM

Full load / No load

Gradeability

20.5 %

Full load

**Based on 5000 lb capacity cushion tire model*



Sweet Savings

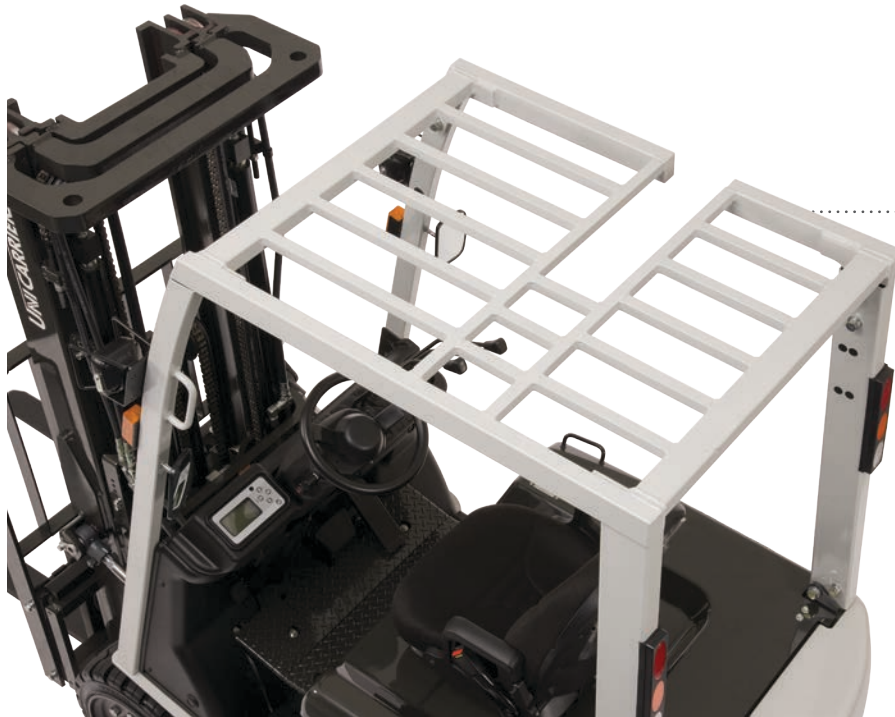

Less service time & expense

OSHA requires replacement of damaged pillars to maintain design integrity. Our five-piece reinforced overhead guard takes an average of 75% less time to make needed replacements versus most competitors.

Save precious battery power

Industrial batteries can be a significant part of your operational expenses. The BX incorporates power saving features to optimize battery usage so you can get the most out of your investment.

An auto power-off cuts the electrical system if the truck sits idle. Standard on all BX trucks, this feature can be adjusted for up to 60 minutes before shutting down the power.

On-demand power steering system draws battery power only when required.

Advanced regenerative braking technologies reclaim energy using five efficient operations, contributing to lower power consumption and longer operating hours. Regeneration also results in reduced heat generation and component wear, for even greater long-term savings.

- 1 Switchback regeneration
- 2 Foot brake regeneration
- 3 Accelerator-off regeneration
- 4 Controlled rollback regeneration
- 5 Lifting/lowering regeneration

Fewer serviceable parts, fewer expenses

The BX incorporates a 100% AC-powered system featuring brushless drive and pump motors and a single contactor. The steering system is electronically controlled and powered through hydraulics, eliminating the need for a separate steering motor.

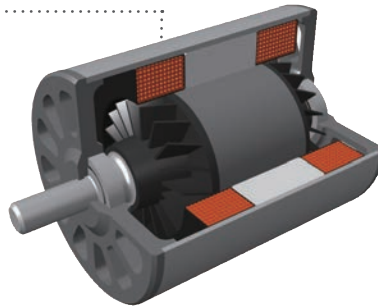

Longer brake and battery life

Program settings so travel speed is reduced once the driver removes his foot from the accelerator. This standard deceleration feature draws less energy and extends brake life.

Minimize preventable repairs

Operators are more likely to perform regular lift truck inspections if they are easy to do. Access to hydraulic and brake fluids are convenient, making daily checks or required refills simple, so operators can focus on the job ahead.

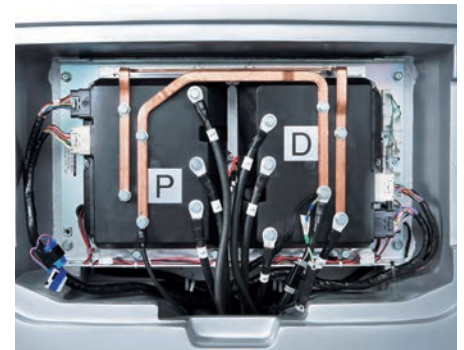

Remove rear panel for access to the controller for inspection and planned maintenance.



Access to hydraulic fluid located under door on right side step, for regular inspections and refills.



Two-piece diamond tread floorboard includes door to access brake fluid for visual level inspection and refills.

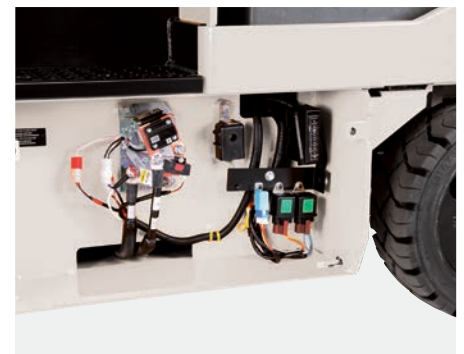

Side panel located behind left entry step offers access to relays and fuses.



Play It Safe



Extra safety measures

Our standard back-up alarm provides plenty of notice to pedestrians and other drivers in the surrounding environment. For applications with varying noise levels, choose an optional self-adjusting alarm that responds based on the environment's ambient volume level.

Reverse driving actuates optional blue spotlight to illuminate the floor, for advanced visual warning.

Rubber damper provides enhanced stability and easier handling

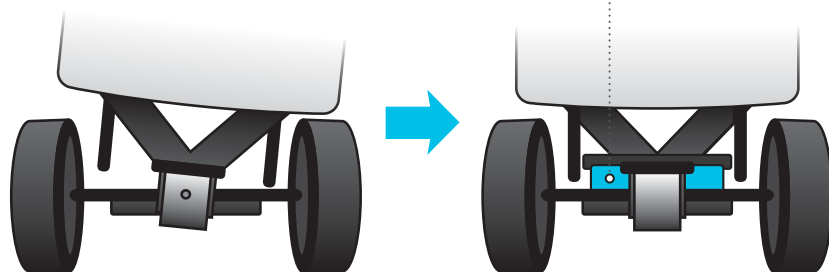

Added stability without added maintenance

A rubber damper between the axle and frame enhances lateral stability. Simple, but extremely effective, and zero maintenance. A UniCarriers exclusive.

Operator Presence System is seat-actuated

Its lift and tilt lock prevents mast operation once the driver leaves the seat. The system includes return-to-neutral as well as reminding the driver to engage his seat belt before starting the forklift. When leaving the seat, it alerts him to set the parking brake.



Exclusive OptiView® Mast delivers greater forward and fork tip visibility

Ideal for facilities that transport delicate loads, our optional OptiView mast makes fork positioning and load handling easier.

Cylinders are positioned behind the mast rails resulting in fewer visual obstructions for the operator.

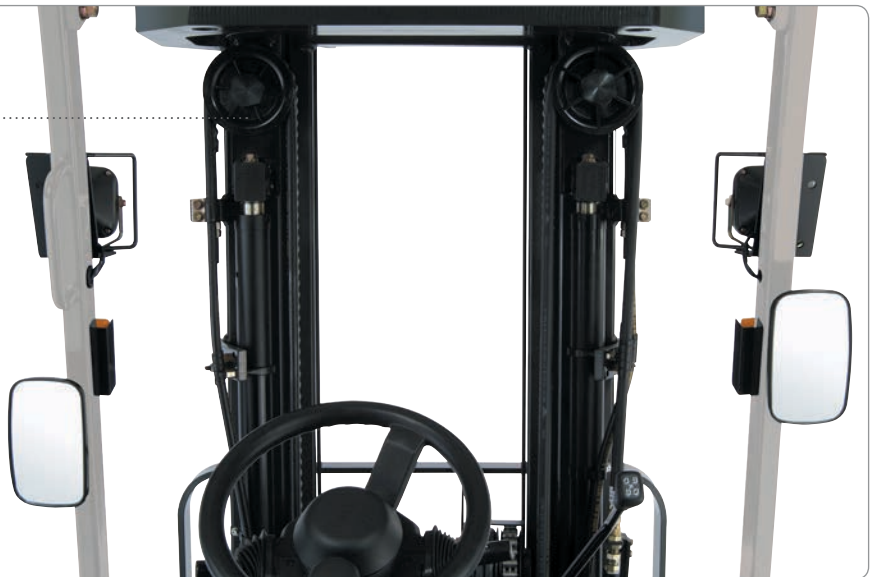

Greater security through PIN code access

A password entry feature helps ensure only qualified drivers are operating the equipment. Up to five performance profile settings can be created, based on operator skill level and/or application requirements.





Control Freak

Greater operator control on inclines

Using regenerative braking, the controlled rollback feature allows the operator to maintain a slow, consistent reverse speed if the accelerator pedal is released while on an incline.



Low effort hand release

Automotive-style parking brake with warning

A warning buzzer alerts the driver if he leaves the seat without setting the brake first. Conveniently located, a foot-activated design eliminates the need for the operator to lean forward to apply the brake. A display indicates when the brake is engaged. Includes a simple hand release.



Multi-tasking taken to a new level

Our innovative single control handle promotes greater productivity by combining lift and tilt operations into one fluid motion. A UniCarriers exclusive. Separate control levers are available at no charge.

Well-informed operators make better decisions

An interactive meter panel provides a wealth of information through its LCD warnings and readout. Use the numbered function keys to program settings, perform maintenance tasks and access service history.

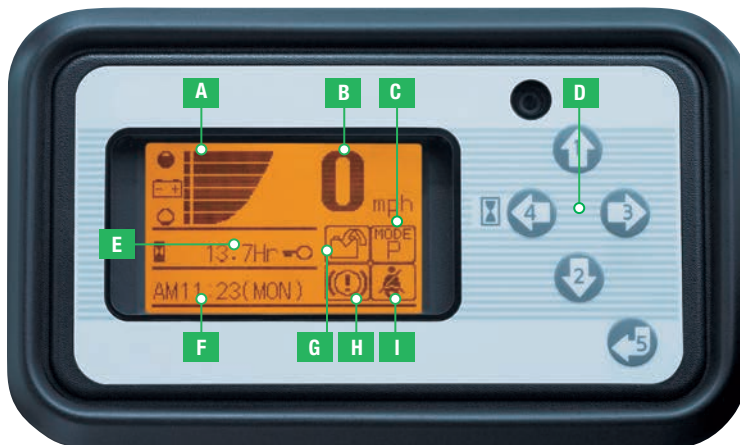

- A** Battery discharge indicator
- B** Speedometer
- C** Power mode
- D** Function keys
- E** Hour meter reading - 4 operational modes
- F** Clock/alarm & acceleration level
- G** Regeneration indicator
- H** Parking brake warning
- I** Seat belt warning

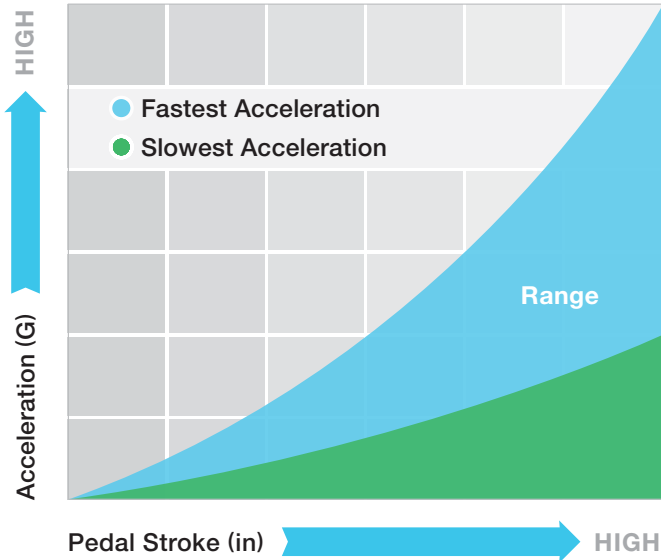

Customize accelerator sensitivity for faster or slower response

Unique Flex-Logic control allows you to set the accelerator pedal's sensitivity depending upon operational requirements or driver skill level. Set parameters for slower acceleration for precise handling in high traffic areas. Choose faster response times for longer runs.





Make it Yours

Choose from a variety of options to customize your ride. If you don't see what you need, contact your authorized Nissan Forklift by UniCarriers dealer for help.



• Pedestrian LED Blue Safety Spot Light

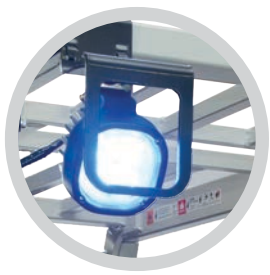

• Strobe Light



• Fire Extinguisher



• Clamp Release Switch



Extended Overhead Guard

Extension provides protection to mounted components, including onboard computer and headlight (shown).

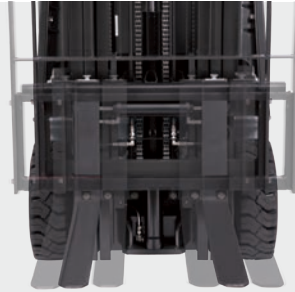

Sidsifting Fork Positioner

Hydraulic fork adjustment prevents operator strain by eliminating the need to manually move forks for different pallet types.

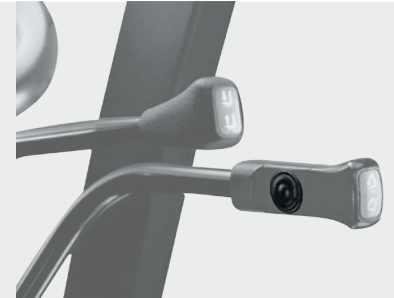

Auto-Fork Leveling

Conveniently located on hydraulic lever, thumb-actuated button is used to automatically tilt the mast forward bringing the forks to 90° for easier load placement and retrieval operations.



Reverse Assist Grip with Horn

Provides operator control while driving in reverse. Keeps operator's hand inside the compartment for safer operation.



High Visibility Seatbelt

Bright orange seatbelt provides instant visual confirmation that operators are maintaining this safety requirement.



Hydraulic Quick Disconnect

Simplifies change-out when multiple attachments are used in an operation.

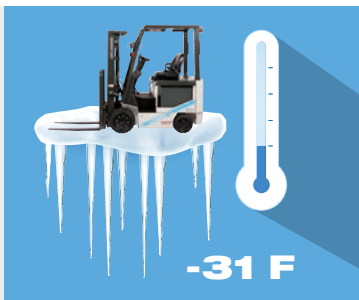

Freezer Package

Provides protection in cold storage or freezer environments in temperatures as low as -31°F (-35°C). Package includes special hydraulic oil and steel tubing, rubber floor mat and tilt cylinder boots.



Steering Wheel Spinner Knob

Provides greater operator control and easier handling.



Accumulator

Ideal when handling fragile loads. Feature absorbs shocks transmitted while driving over uneven or cracked floors to make load handling and travel smoother.

Option Availability

● Standard ○ Optional

	CUSHION	PNEUMATIC
VEHICLE MANAGEMENT		
AC TECH motor controller system	●	●
Interactive LCD meter panel with adjustable performance settings	●	●
Operator security PIN access	●	●
3 pre-set performance modes (economy, normal, high)	●	●
1 manual (custom) performance mode	●	●
On-board diagnostics, self test & coded service history	●	●
Low battery Lift Interrupt System	●	●
Controlled rollback	●	●
BATTERY/ELECTRICAL		
36 Volt system	●	
48 Volt system	○	●
Battery compartment rollers	○	
BRAKE		
Foot-applied parking brake with warning buzzer	●	●
5-mode regenerative braking	●	●
MAST		
Seat actuated auto-mast lock system	●	●
OptiView® three-stage mast	○	○
High-visibility carriage (up to 5,000 lbs capacity)	○	○
HYDRAULIC SYSTEM		
Single lift/tilt control lever	●	●
Separate lift & tilt control levers	○	○
Auto-fork leveling	○	○
Accumulator	○	○
Extra tilt	○	○
Quick disconnect	○	○
OPERATOR CONVENIENCES		
Full suspension seat with weight & lumbar adjustment	●	●
OHG-mounted headlights	●	●
Rearview mirrors	○	○
Rear combination light package (turn, stop, back-up)	○	○
Rear work and strobe lights	○	○
Secure assist grip with horn button	○	○
Steering wheel with spinner knob	○	○
Magnetic convenience tray	○	○
SAFETY/SECURITY		
Fire extinguisher	○	○
Operator Presence System with return-to-neutral & auto-mast lock	●	●
Back-up warning alarm	●	●
Self-adjusting back up alarm	○	○
Orange seat belt	○	○

Some options may require additional lead time. Consult your local authorized UniCarriers Americas Dealer for details.
 BX pneumatic tire models conform to UL583 Type E.
 BX cushion tire models comply to UL583 Type ES, with optional Type EE compliance. Consult Factory for details.

Specifications

CUSHION TIRE 3000 – 8000 LB. MODELS

SHORT MODEL CODES	BXC30N	BXC35N	BXC40N	BXC50N	BXC50LN*	BXC60N	BXC80N
Load Capacity - lb	3000	3500	4000	5000	5000	6000	8000
Voltage	36 / 48	36 / 48	36 / 48	36 / 48	36 / 48	36 / 48	36 / 48
Max Travel Speed 36V loaded/empty - mph	9.0 / 10.6	9.0 / 10.3	10.3 / 10.6	9.3 / 10.6	9.3 / 10.6	8.1 / 9.3	7.1 / 9.0
Max Travel Speed 48V loaded/empty - mph	9.0 / 10.6	9.0 / 10.3	10.3 / 10.6	9.3 / 10.6	9.3 / 10.6	8.7 / 9.3	7.8 / 9.0
Max Lift Speed - loaded 36/48 Volt - fpm	66.0 / 85.7	59.1 / 76.8	69.0 / 75.8	63.0 / 67.9	63.0 / 67.9	50.2 / 55.1	43.3 / 46.3
Max Lift Speed - empty 36/48 Volt - fpm	105.3 / 126.0	105.3 / 126.0	108.3 / 119.1	108.3 / 119.1	108.3 / 119.1	92.5 / 101.4	77.8 / 84.7
Min Outside Turning Radius - in	70.9	70.9	72.6	73.8	78.9	81.1	88.4
Overhead Guard Height - in	86.2	86.2	87.4	87.4	87.4	87.4	87.4

* Long Wheelbase Model

PNEUMATIC TIRE (STANDARD WHEELBASE) 3000 – 5000 LB. MODELS

SHORT MODEL CODES	BXP30N	BXP35N	BXP40N	BXP50N
Load Capacity - lb	3000	3500	4000	5000
Voltage	48	48	48	48
Max Travel Speed - loaded/empty - mph	9.9 / 11.2	9.9 / 10.9	9.3 / 10.6	9.3 / 10.6
Max Lift Speed - loaded/empty - fpm	85.7 / 126.0	76.8 / 126.0	75.8 / 119.1	67.9 / 119.1
Min Outside Turning Radius - in	68.9	70.1	77.2	78.7
Overhead Guard Height - in	83.5	83.5	83.5	83.5

PNEUMATIC TIRE (LONG WHEELBASE) 3000 – 5000 LB. MODELS

SHORT MODEL CODES	BXP30LN	BXP35LN	BXP40LN	BXP50LN
Load Capacity - lb	3000	3500	4000	5000
Voltage	48	48	48	48
Max Travel Speed - loaded/empty - mph	9.9 / 10.9	9.9 / 10.9	9.3 / 10.6	9.3 / 10.6
Max Lift Speed - loaded/empty - fpm	85.7 / 126.0	76.8 / 126.0	75.8 / 119.1	67.9 / 119.1
Min Outside Turning Radius - in	77.6	77.6	84.3	84.3
Overhead Guard Height - in	83.5	83.5	89.6	89.6

Built Like No Others.
Backed Like Nothing Else.



Quality, performance, reliability and efficiency — we believe that the same attributes that make a great forklift are also essential elements of an exceptional company. As a result we've built an organization that overlooks no detail in manufacturing material handling equipment, that delivers the highest level of **performance and value** — and that stands behind our products with comprehensive service and support.

Our products are designed to produce maximum productivity without compromising operator safety. **They're built to exacting standards to maximize uptime.** They're scrupulously tested to ensure strict tolerances are met — and offered by a network of highly skilled, factory trained professionals committed to customer satisfaction.

And when it comes to the environment, we put the same passion and energy into creating an effective sustainability initiative as we put into engineering our products.

At UniCarriers, our mission is to **continuously move performance standards upward** — and to provide the support you need to **move your business forward.**

SB-BX PLATINUM 06-2014
Printed in U.S.A.



UniCarriers® is a registered trademark of UniCarriers Corporation. OptiView is a registered trademark of UniCarriers Americas Corporation. UniCarriers Americas Corporation reserves the right to make product changes relating to colors, equipment, specifications or available options without notice.

For more information, contact your UniCarriers Americas Corporation representative.

UNI CARRIERS®
UniCarriers Americas Corporation
UniCarriersAmericas.com