

NISSAN
FORKLIFT

TX Platinum Series

Cushion Tire / 36 & 48 Volt Models / **3-Wheel AC-Powered Models**

3,000/3,500/4,000 lb.
Capacities



Dimensions

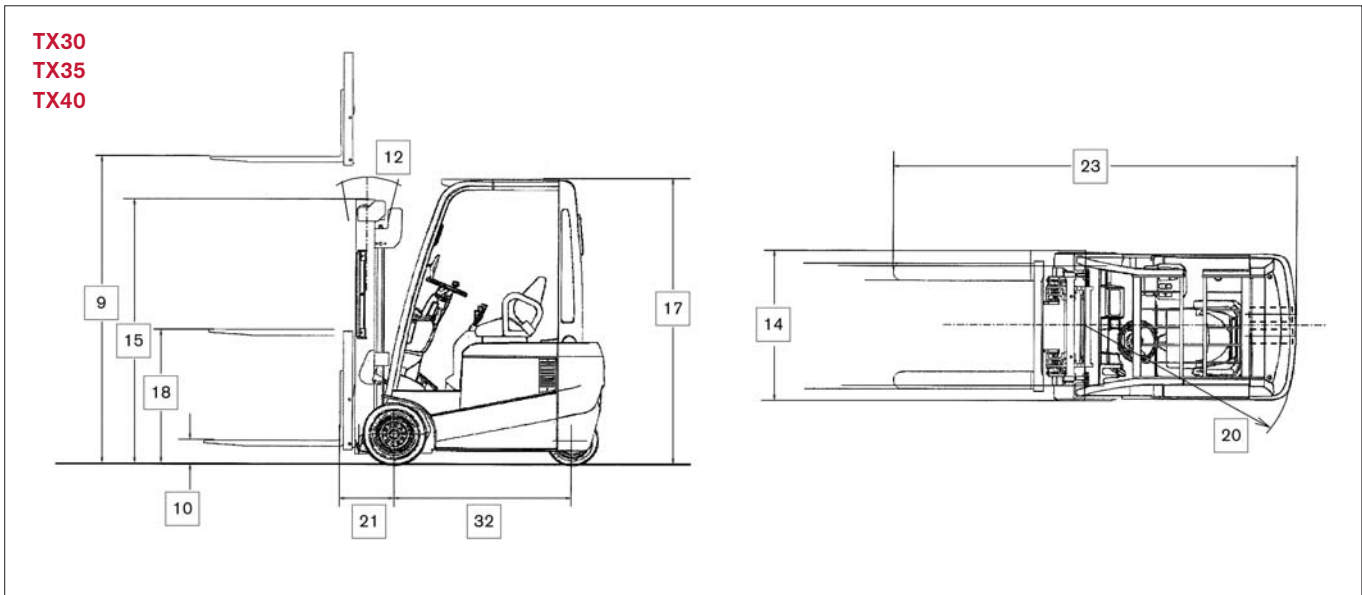

Mast Specifications & Rated Capacities

	Mast Name	Maximum Fork Height	Overall Height Lowered	Free Lift	Tilt angle Forward/Backward	Rated Capacity at 24" Load Center		
						TX30	TX35	TX40
TWO STAGE (Wide view)	2W270	106	71.1	2.4	4/6	3000	3500	4000
	2W300	118	77.0	2.4	4/6	3000	3500	4000
	2W330	130	82.9	2.4	4/6	3000	3500	4000
	2W350	138	88.2	2.4	4/6	3000	3500	4000
	2W370	146	93.1	2.4	4/6	3000	3500	4000
	2W400	157	100.6	2.4	4/6	3000	3500	3900
	2W450	177	110.4	2.4	4/6	2900	3300	3700
	2W500	197	120.3	2.4	4/6	2800	3100	3600
TWO STAGE (Full free)	2F270	106	71.1	48.2	4/6	3000	3500	4000
	2F300	118	77.0	54.1	4/6	3000	3500	4000
	2F330	130	82.9	60.0	4/6	3000	3500	4000
	2F350	138	88.2	65.4	4/6	3000	3500	4000
	2F370	146	93.1	70.3	4/6	3000	3500	4000
	2F400	157	100.6	77.8	4/6	3000	3400	3900
THREE STAGE (Full free)	3F385	152	71.1	47.2	5/5	3000	3400	3800
	3F430	169	77.0	54.1	5/5	2900	3300	3700
	3F475	187	82.9	60.0	5/5	2800	3200	3600
	3F515	203	88.2	65.4	5/5	2700	3100	3500
	3F550	217	93.1	70.3	5/5	2600	2900	3400
	3F600	236	100.6	77.8	5/5	2300	2400	3300
	3F650	256	110.4	87.6	5/5	1900	N/A	3200
	3F700	276	120.3	97.4	5/5	1400	N/A	3000
THREE STAGE Optiview	3V360	142	71.1	49.6	5/5	2800	3000	3700
	3V405	159	77.0	55.5	5/5	2700	3000	3600
	3V450	177	82.9	61.4	5/5	2700	3000	3400
	3V490	193	88.2	66.7	5/5	2600	2900	3300
	3V525	207	93.1	75.6	5/5	2500	2800	3200
	3V575	226	100.6	79.1	5/5	2300	2400	3100
	3V633	249	110.4	89.0	5/5	1900	N/A	3000
	3V688	271	120.3	98.8	5/5	1400	N/A	2900

Free Lift: without backrest

3,000/3,500/4,000 lb. capacities

Main Truck Specifications

				Nissan	Nissan	Nissan		
CHARACTERISTICS	1	Manufacturer's Name		Nissan	Nissan	Nissan	1	
	2	Model	Model designation	TX30	TX35	TX40	2	
			Long model code	1N1L15V	1N1L18V	G1N1L20V		
	3	Rated Load Capacity	lb (kg)	3000 (1500)	3500 (1750)	4000 (2000)	3	
	4	Load Center	Distance	in (mm)	24 (500)	24 (500)	24 (500)	4
	5	Power Type	Electric		36 / 48 Volt	36 / 48 Volt	36 / 48 Volt	5
6	Operator Orientation			Sit	Sit	Sit	6	
DIMENSIONS	7	Tire Type	Front & rear	Cushion	Cushion	Cushion	7	
	8	Wheels	Number (x=driven) front/rear	2 x / 2	2 x / 2	2 x / 2	8	
	9	Mast	Maximum fork height	in (mm)	118 (3000)	118 (3000)	118 (3000)	9
			Standard freelif	in (mm)	2.4 (60)	2.4 (60)	2.4 (60)	
	11	Forks	Thickness & width	in (mm)	1.5 x 4 (40x100)	1.5 x 4 (40x100)	1.5 x 4 (40x100)	11
			Length (STD)	in (mm)	42 (1070)	42 (1070)	42 (1070)	
	12	Tilt Angle	Standard mast - fwd/back	degree	4 / 6	4 / 6	4 / 6	12
	13	Overall Dimensions	Length (to face of forks)	in (mm)	74.4 (1890)	74.6 (1895)	78.9 (2005)	13
			Width (standard tires)	in (mm)	43.5 (1105)	43.5 (1105)	43.5 (1105)	
			Mast lowered (OHL)	in (mm)	77.0 (1955)	77.0 (1955)	77.0 (1955)	
			Mast extended with LBR	in (mm)	167.7 (4260)	167.7 (4260)	167.7 (4260)	
			Height - top of OHG	in (mm)	83.4 (2120)	83.4 (2120)	83.4 (2120)	
			Height - top of standard LBR	in (mm)	47 (1194)	47 (1194)	47 (1194)	
Width - standard carriage			in (mm)	36.2 (920)	36.2 (920)	36.2 (920)		
20	Turning Radius	Minimum outside*	in (mm)	60.0 (1525)	60.0 (1525)	64.4 (1635)	20	
21	Overhang	Front	in (mm)	14.4 (365)	14.6 (370)	14.6 (370)	21	
		Rear	in (mm)	8.6 (219)	8.6 (219)	8.6 (219)		
22							22	
23	Min Right Angle Stack	Add load length & clearance	in (mm)	74.4 (1890)	74.6 (1895)	79.0 (2005)	23	
PERFORMANCE	24	Speeds Maximum	Travel - loaded/empty (36V)	mph (km/h)	9 (14.5) / 9 (14.5)	9 (14.5) / 9 (14.5)	9 (14.5) / 9 (14.5)	24
			Travel - loaded/empty (48V)	mph (km/h)	10 / 10 (16/16)	10 / 10 (16/16)	10 / 10 (16/16)	
	25		Lift - loaded/empty (36V)	fpm (mm/sec)	67 / 101 (340 / 515)	61 / 101 (310 / 515)	53 / 101 (270 / 515)	25
			Lift - loaded/empty (48V)	fpm (mm/sec)	79 / 118 (400 / 600)	73 / 118 (370 / 600)	63 / 118 (320 / 600)	
			Lowering - loaded/empty (36V/48V)	fpm (mm/sec)	98 / 107 (500 / 550)	98 / 107 (500 / 550)	98 / 107 (500 / 550)	
	26	Drawbar Pull Maximum	Full load - 3 min rating	lb (kg)	2280 (1030)	2280 (1030)	2280 (1030)	26
27	Gradeability Maximum	Full load / empty - 5 min rating	tan (%)	20.8 / 32.3	18.7 / 30.0	16.1 / 26.0	27	
WEIGHT	28	Truck Weight	No load, no battery	lb (kg)	5220 (2370)	5640 (2560)	5285 (2400)	28
	29		No load, min battery	lb (kg)	6765 (3070)	7185 (3260)	7600 (3450)	29
	30	Weight Distribution	Full load front/rear - min battery	lb (kg)	8685 / 1080 (3940 / 490)	9585 / 1100 (4345 / 500)	10575 / 1025 (4805 / 465)	30
No load front/rear - min battery			lb (kg)	3430 / 3335 (1555 / 1515)	3435 / 3750 (1560 / 1700)	3785 / 3815 (1720 / 1730)		
CHASSIS & WHEELS	31	Tire Size	Front	in	18 x 7 x 12.1	18 x 7 x 12.1	18 x 7 x 12.1	31
			Rear	in	15 x 5 x 11.25	15 x 5 x 11.25	15 x 5 x 11.25	
	32	Wheelbase		in (mm)	51.2 (1300)	51.2 (1300)	55.5 (1410)	32
	33	Tread - Center of Tire	Front / rear	in (mm)	36.6 / 6.9 (930 / 176)	36.6 / 6.9 (930 / 176)	36.6 / 6.9 (930 / 176)	33
			Counterweight Height	in (mm)	36.2 (920)	36.2 (920)	36.2 (920)	
			Step Height	in (mm)	21.9 (556)	21.9 (556)	21.9 (556)	
	34	Ground Clearance	Under mast	in (mm)	3.0 (75)	3.0 (75)	3.0 (75)	34
Under frame (WB center)			in (mm)	3.9 (100)	3.9 (100)	3.9 (100)		
DRIVE LINE	35	Service Brake	Type	Hydraulic / Electric	Hydraulic / Electric	Hydraulic / Electric	35	
	36	Parking Brake	Type	Hand	Hand	Hand	36	
	37	Steering	On-demand		Hydraulic	Hydraulic	Hydraulic	37
	38	Traction Motor x2	Rating (1 hour) - 36 Volt / 48 Volt	kW	4.0 / 5.0	4.0 / 5.0	4.0 / 5.0	38
			Control type		MOS-FET Inverter	MOS-FET Inverter	MOS-FET Inverter	
	39	Pump Motor	Rating (5-min.) - 36 Volt / 48 Volt	kW	8.0 / 11.0	8.0 / 11.0	8.0 / 11.0	39
	BATTERY	40	Recommended Size	L x W x H	in (mm)	38.78 x 20.55 x 25.63 (985 x 522 x 651)	38.78 x 24.88 x 25.63	40
			Battery Compartment Size	L x W x H	in (mm)	39.17 x 20.86 x 25.78 (995 x 530 x 655)	39.17 x 25.19 x 25.78	
				Lead acid - 36 Volt / 48 Volt	Type	18-100-17 / 24-100-13	18-100-17 / 24-100-15	
			Capacity at 6 hour rate	Minimum - 36 / 48 Volt	Ah	680 / 510	680 / 510	750 / 600
Maximum - 36 / 48 Volt				Ah	800 / 600	800 / 600	1000 / 700	
41		Weight**	Minimum / Maximum	lb (kg)	1545 / 2425 (700 / 1100)	1545 / 2205 (700 / 1000)	2315 / 2535 (1050 / 1150)	41
42	Lead Length	Position A	in (mm)	4.0 (100)	4.0 (100)	4.0 (100)	42	
43	Connector		Type	SB-350 Gray	SB-350 Gray	SB-350 Gray	43	

*Turning radius calculated using standard dual cushion tires.

**Min/max battery weight based on cushion tire models only. Consult Factory for battery weight requirements for pneumatic tire models.

Technical Information

TX Platinum Series

Standard Equipment

1. 36/48-volt electrical system
2. Enclosed, AC-powered hydraulic pump motor and dual drive motors
3. On-demand, hydraulic load sensing power steering system
4. Nissan AC TECH controller works in conjunction with built-in test equipment and multi-function LCD display
5. On-board diagnostics and service history
6. Three standard performance modes: economy, normal, high
7. Nissan's Safety System includes seat-actuated power interrupt system
8. Secure access to personalized performance settings
9. Deck-mounted hydraulic control levers
10. Three-mode regenerative braking system
11. Enclosed, six-disc wet type brakes
12. Controlled rollback feature reduces truck descent while on inclines
13. Infinitely adjustable, small diameter tilt steering wheel
14. Full suspension cloth seat with operator restraint system and weight adjustment
15. Audible back-up warning alarm
16. Two front overhead guard mounted headlights, turn signals and mirrors
17. Rear combination turn signal, brake, and stop lights
18. Rear work light
19. Four-piece reinforced overhead guard
20. Dual cushion rear steer tires
21. Deck mounted emergency stop button

Optional Equipment

1. Adjustable armrest with fingertip hydraulic controls
2. Single lift/tilt control (available only with fingertip option)
3. Battery compartment rollers
4. Nissan exclusive three-stage Optiview mast
5. Integral side shifter
6. Solid pneumatic tires
7. Freezer package (-31°F / -35°C)
8. High position steering wheel (2.2" additional height)
9. Low overhead guard (78.3")
10. Strobe lights
11. Fire extinguisher
12. Standard or polished and tapered forks in a variety of lengths

Enhanced Operator Comfort and Productivity

The TX Series offers a variety of operator conveniences for enhanced comfort and increased productivity, including a full suspension cloth seat with weight and back-angle adjustment, hip restraint and retractable seat belt. A compact front cowl design offers generous leg and foot room along with a wide entry step. Its infinitely adjustable steering wheel column offers a wide range of up and down movement. Additional ergonomics are achieved through an optional higher steering column design.

TX Series' AC TECH offers Flex-logic acceleration control which enables the truck to respond according to the speed with which the pedal is depressed, allowing more accurate, precise control by the driver. The hydraulic, AC-powered steering system reduces operator effort, for easier, more maneuverable conditions, while a hydraulic load sensing valve diverts fluid for priority to the steering system.

Dual lift and tilt lever, deck-mounted hydraulic controls are standard. An adjustable armrest with fingertip control hydraulics can be ordered as an option, and is available with Nissan's exclusive single lift/tilt design, resulting in enhanced ergonomics, and further improving productivity.

The LCD dash display visibly communicates truck status and warnings for operator awareness including: travel speed (above 2 mph) and rear wheel angle indicator (less than 2 mph), battery capacity, hour meter (four-mode), time and day of week, brake warning, seat belt warning and selected power mode.

The TX Series' standard Safety System includes: Mast Lock (automatically locking mast lift and tilt when the operator leaves the seat), Turn Control (automatic restriction of travel speed and acceleration during turning), Lift Control (restricting lift speed at faster travel speeds) and Controlled Rollback (reducing quick truck movement down a gradient, when the accelerator pedal is released).

Features for Increased Efficiency

The TX Series' AC TECH controller provides lower battery consumption and optimum operating efficiencies through regenerative braking, automatic deceleration and on-demand power steering. Regenerative braking is achieved through switch-back/plugging; foot applied braking and neutral braking. An adjustable auto-power off feature will switch off the electrical system if the truck isn't being operated, further extending battery life.

A four-digit PIN code offers access to adjustable performance settings, allowing up to five unique operational profiles according to driver experience and load handling conditions. Or select from three preset performance modes (economy, normal, high) based on the application.

Battery and Electrical

Available with a 36 or 48 volt electrical system. The AC TECH motor controller features a MOS-FET power inverter for DC to three phase AC power conversion. Single contactor design reduces maintenance.

Brake System

Six-disc wet type brakes prolong brake life and offer constant braking efficiency. Brakes are fully enclosed within the drive unit, to prevent dust and dirt contamination. Six-disc type brake achieves higher braking performance over the life of the brakes. Three-mode regenerative braking system increases the number of working hours per battery charge. A hand-actuated parking brake, with lock release button is located on the cowl within easy reach.

Truck and Mast Design

Modern and compact wedge-shaped design makes the truck highly maneuverable in confined areas. Standard dual rear wheels provide additional stability, especially during high loading conditions, while the lift control feature restricts lift speeds during faster travel.

Nissan's flat face mast design features rolled steel channels, large cross sections, and thick inner rails for increased capacity retention. Side thrust rollers on the fork carriage are easily accessed for carriage adjustment. Optional Nissan exclusive Optiview, three-stage mast design offers 50% greater visibility for improved load handling.

Drive Unit

Dual front wheel drive provides excellent traction and braking power. Rugged dual AC drive motors offer more power and quicker response. The TX Series' individually controlled AC powered drive motors mean power is permitted to each motor depending upon turn angle input. For tighter turns, the inner wheel counter-rotates allowing the truck to turn on the spot.

Hydraulics

Powerful AC hydraulic pump motor for lift and tilt operation is also used for the on demand power steering system.

Reduced Maintenance

The TX Platinum Series features a 100% AC-powered system, including brushless, dual drive motors and a hydraulic pump motor (which also powers the steering system). On-demand steering achieved through priority hydraulic load sensing valve, eliminating use of separate steering motor. Design greatly reduces the number of serviceable parts including commutators, contactors, brushes and steer chains; eliminating expenses related to inspection and replacement of these items, for lower overall operating costs. Four-piece reinforced overhead guard design allows easy replacement should individual parts become damaged.

Enclosed six-disc wet brake system prevents friction and glazing, as well as eliminating dirt entry, to prevent premature wear and superfluous maintenance expenses. Frame-mounted mast design allows easier access to final drive, eliminating need to disassemble transmission and drive motors to gain access to the brakes.

The AC TECH controller includes a built-in-test-equipment module with self-diagnostics and allows coded service history, logged by hour meter reading. Troubleshooting through the instrument panel allows rapid access to service requirements. Rugged, gas spring de-tent keeps the hood up and out of the way during routine battery maintenance inspections. Removable two-piece floorboard provides access to drive and hydraulic pump motors. Hydraulic oil tank location makes daily level checks and periodic refills fast and simple.



ISO 14001:2004
NISSAN GREEN PROGRAM

Nissan Forklift Corporation reserves the right to make product changes relating to colors, equipment, specifications or available options without notice. For more information, contact your Nissan Forklift representative.

NISSAN
FORKLIFT

NISSAN
FORKLIFT

SCX Platinum Series

Cushion Tire / 36 Volt Models / 3-Wheel Stand-Up AC-Powered Models

3,000/3,500/4,000 lb.
Capacities



Dimensions

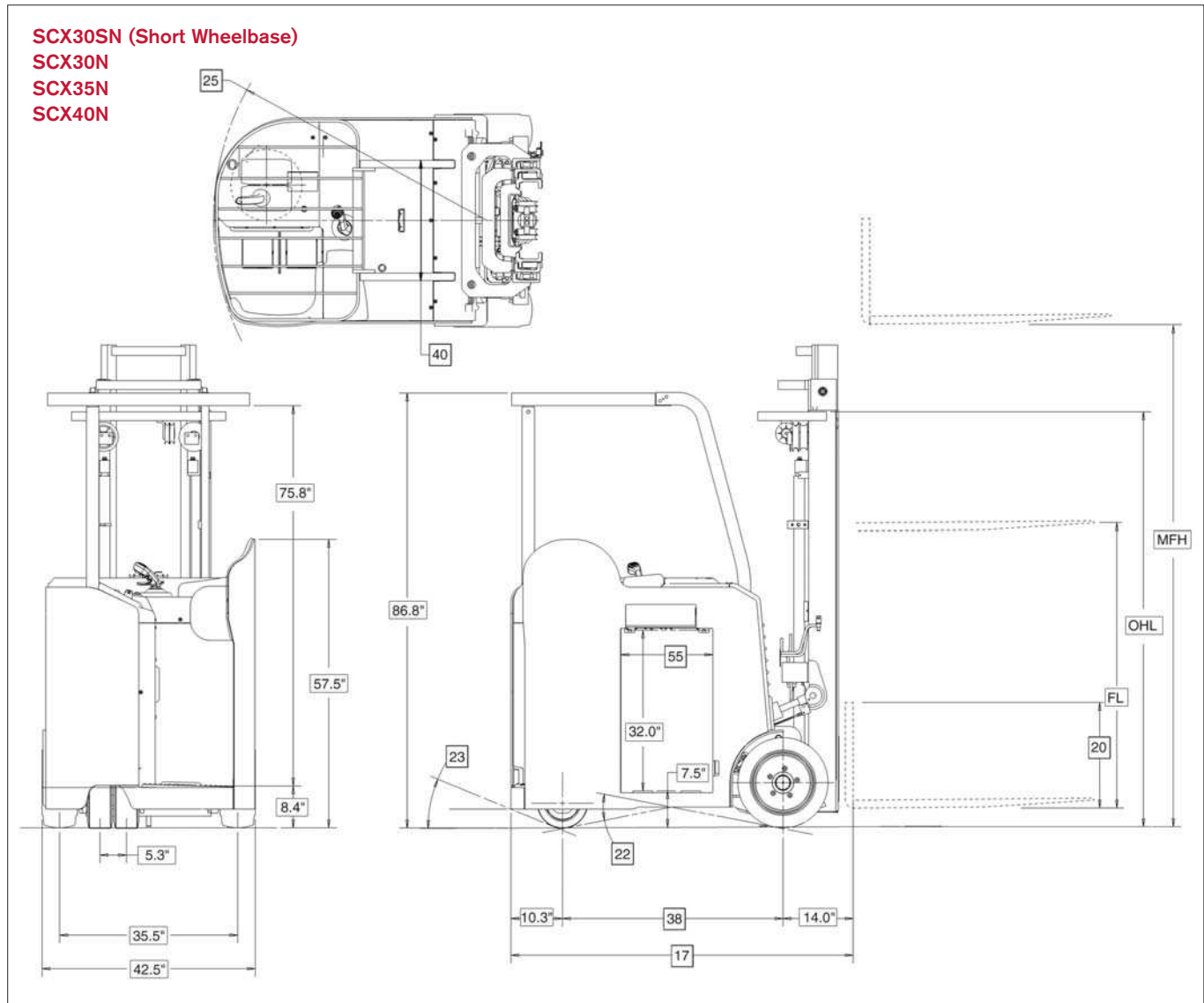

Mast Specifications & Rated Capacities

Mast Type	Mast Name	Maximum Fork Height	Overall Height				Free Lift		Tilt Angle	Rated Capacity at 24" Load Center				
			Lowered		Fully Extended		FL			SCX30S	SCX30	SCX35	SCX40	
			MFH	OHL	With LBR	Without LBR	With LBR	Without LBR						Fwd/Bkwd
			in	in	in	in	in	in						
THREE STAGE (Full Free)	3F385	152	71.3	200.9	168.3	23.3	46.9	4/4	3000	3000	3500	4000		
	3F430	169	77.2	218.7	186.0	29.2	52.8	3/5	3000	3000	3500	4000		
	3F475	187	83.1	236.4	203.7	35.1	58.7	3/5	3000	3000	3500	4000		
	3F515	203	88.5	252.3	219.7	40.4	64.0	3/5	2950	2950	3475	3675		
	3F550	217	93.4	265.9	233.3	45.3	68.9	3/5	2900	2900	3350	3425		
	3F600	236	100.9	285.6	253.0	52.8	76.4	3/5	2800	2800	3150	3150		
	3F650	256	110.7	305.3	275.8	62.6	86.2	3/5	2725	2725	2900	2900		
	3F700	276	120.6	325.0	297.4	72.5	96.1	3/5	2625	2625	2700	2700		

3,000/3,500/4,000 lb. capacities

Main Truck Specifications

				Nissan	Nissan	Nissan	Nissan		
CHARACTERISTICS	1	Manufacturer's Name		Nissan	Nissan	Nissan	Nissan	1	
	2	Model	Model designation	SCX30SN	SCX30N	SCX35N	SCX40N	2	
	3		Long model code	S1S1L15NV	1S1L15NV	1S1L18NV	1S1L20NV	3	
	4	Rated Load Capacity	lb (kg)	3000 (1500)	3000 (1500)	3500 (1800)	4000 (2000)	4	
	5	Load Center	Distance	in (mm)	24 (600)	24 (600)	24 (600)	24 (600)	5
	6	Power Type	Electric	voltage	36v	36v	36v	36v	6
	7	Operator Orientation			Stand-Up	Stand-Up	Stand-Up	Stand-Up	7
DIMENSIONS	8	Tire Type	Front & rear	Cushion Poly	Cushion Poly	Cushion Poly	Cushion Poly	8	
	9	Wheels	Number front / rear (x=driven)	2 x / 2	2 x / 2	2 x / 2	2 x / 2	9	
	10	Mast	Maximum fork height	in (mm)	187 (4750)	187 (4750)	187 (4750)	187 (4750)	10
	11		Mast lowered (OHL)	in (mm)	82.9 (2105)	82.9 (2105)	82.9 (2105)	82.9 (2105)	11
	12		Mast extended with LBR	in (mm)	236.6 (6010)	236.6 (6010)	236.6 (6010)	236.6 (6010)	12
	13		Standard freelif	in (mm)	58.7 (1490)	58.7 (1490)	58.7 (1490)	58.7 (1490)	13
	14		Mast width (rail width)	in (mm)	24.8 (630)	24.8 (630)	24.8 (630)	24.8 (630)	14
	15	Forks	Length x width x thickness	in (mm)	42 x 4 x 1.5 (420 x 100 x 40)		42 x 4 x 1.5 (420 x 100 x 40)		15
	16	Tilt Angle	Standard mast - fwd/back	degree	3 / 5	3 / 5	3 / 5	3 / 5	16
	17	Overall Dimensions	Length (to face of forks)	in (mm)	66 (1680)	68.2 (1735)	68.2 (1735)	70.5 (1790)	17
	18		Width (standard tires)	in (mm)	42.5 (1080)	42.5 (1080)	42.5 (1080)	42.5 (1080)	18
	19		Height - top of OHG	in (mm)	86.8 (2205)	86.8 (2205)	86.8 (2205)	86.8 (2205)	19
	20		Height - top of standard LBR	in (mm)	48 (1220)	48 (1220)	48 (1220)	48 (1220)	20
	21		Width - standard carriage	in (mm)	36.2 (920)	36.2 (920)	36.2 (920)	36.2 (920)	21
22	Grade Clearance	Ramp breakover angle	%	43.3	40.8	40.8	38.4	22	
23		Departure angle	%	41	41	41	41	23	
24	Overhang	Front / rear	in (mm)	14 (355) / 10.3 (260)	14 (355) / 10.3 (260)	14 (355) / 10.3 (260)	14 (355) / 10.3 (260)	24	
25	Turning Radius	Minimum outside	in (mm)	52.3 (1330)	54.5 (1385)	54.5 (1385)	56.8 (1445)	25	
26	Min Right Angle Stack	Add load length & clearance	in (mm)	66.3 (1685)	68.5 (1740)	68.5 (1740)	70.8 (1800)	26	
PERFORMANCE	27	Speeds Maximum	Travel - loaded / unloaded	mph (km/h)	7.8 (12.6) / 8.0 (12.9)	7.8 (12.6) / 8.0 (12.9)	7.8 (12.6) / 8.0 (12.9)	7.6 (12.2) / 8.0 (12.9)	27
	28		Lift - loaded / unloaded	fpm (mm/sec)	71 (362) / 114 (577)	71 (362) / 114 (577)	66 (334) / 114 (577)	62 (317) / 114 (577)	28
	29		Lowering - loaded / unloaded	fpm (mm/sec)	92 (469) / 93 (472)	92 (469) / 93 (472)	91 (463) / 93 (472)	93 (470) / 93 (472)	29
30	Gradeability Maximum	Full load	(%)	29.1	27.6	26.9	26.1	30	
WEIGHT	31	Truck Weight	Empty, min. battery	lb (kg)	8240 (3740)	8445 (3830)	9370 (4250)	10435 (4735)	31
	32	Weight Distribution	Full load - min. battery - front	lb (kg)	9655 (4380)	9955 (4515)	11030 (5005)	12755 (5785)	32
	33		Full load - min. battery - rear	lb (kg)	1585 (720)	1490 (675)	1840 (835)	1680 (765)	33
	34		No load - min. battery - front	lb (kg)	3920 (1780)	4330 (1965)	4480 (2030)	5220 (2370)	34
	35		No load - min. battery - rear	lb (kg)	4320 (1960)	4115 (1865)	4890 (2220)	5215 (2365)	35
CHASSIS & WHEELS	36	Tire Size	Front	in	18 x 7 x 12-1/8	18 x 7 x 12-1/8	18 x 7 x 12-1/8	18 x 7 x 12-1/8	36
	37		Rear	in	10 x 5 x 6-1/2	10 x 5 x 6-1/2	10 x 5 x 6-1/2	10 x 5 x 6-1/2	37
	38	Wheelbase		in (mm)	41.8 (1065)	43.9 (1115)	43.9 (1115)	46.3 (1175)	38
	39	Tread - Center of Tire	Front / rear	in (mm)	35.5 (900) / 5.3 (135)	35.5 (900) / 5.3 (135)	35.5 (900) / 5.3 (135)	35.5 (900) / 5.3 (135)	39
	40	OHG Post Spread	Outside-to-outside	in (mm)	24 (610)	24 (610)	24 (610)	24 (610)	40
	41	Chassis Height		in (mm)	57.5 (1460)	57.5 (1460)	57.5 (1460)	57.5 (1460)	41
	42	Headroom	Floor to bottom of OHG	in (mm)	75.8 (1925)	75.8 (1925)	75.8 (1925)	75.8 (1925)	42
	43	Ground Clearance	Lowest point	in (mm)	2.1 (55)	2.1 (55)	2.1 (55)	2.1 (55)	43
	44		Under frame, center of wheelbase	in (mm)	4.0 (100)	4.0 (100)	4.0 (100)	4.0 (100)	44
	45	Service Brake	Type		Regen	Regen	Regen	Regen	45
46	Parking Brake	Type		Auto-Applied / Electronic Release		Auto-Applied / Electronic Release		46	
47	Steering	On-demand		Hydraulic	Hydraulic	Hydraulic	Hydraulic	47	
48	Traction Motor	Type		AC Induction	AC Induction	AC Induction	AC Induction	48	
49		Control type		AC Inverter	AC Inverter	AC Inverter	AC Inverter	49	
51	Pump Motor	Type		AC Induction	AC Induction	AC Induction	AC Induction	51	
53	Hydraulic Control			Electroproportional	Electroproportional	Electroproportional	Electroproportional	53	
BATTERY	54	Battery Compartment Size	W x H - Maximum	in (mm)	38.5 x 32 (975 x 810)		38.5 x 32 (975 x 810)		54
	55		L - Maximum	in (mm)	16.3 (415)	18.4 (465)	18.4 (465)	20.8 (530)	55
	56	Battery	Lead acid	Type	18-125-13	18-125-15	18-125-15	18-125-17	56
	57		Max. Capacity - 6 hr. rating	Ah	930	1085	1085	1240	57
	58	Weight	Minimum / Maximum	lb (kg)	1885 (855) / 2400 (1085)	2175 (990) / 2700(1225)	2175 (990) / 2700 (1225)	2460(1115) / 3000(1360)	58
	59	Lead Length	Position B / SB-350 Gray	in (mm)	14 (355)	14 (355)	14 (355)	14 (355)	59

Technical Information **Platinum SCX Series**

Standard Equipment

1. 36-volt electrical system
2. AC-powered hydraulic pump motor and dual drive motors
3. Multi-function LCD display
4. BDI with lift interrupt
5. Three hour meters
6. Speedometer
7. Steer tire position indicator
8. On-board diagnostics with built-in test equipment
9. Operator security PIN access
10. Parking brake warning light and operator presence indicator light
11. Three pre-set standard performance modes—economy, power, high settings, along with a manual setting
12. Nissan's operator presence system includes return-to-neutral and mast-lockout
13. Reduced speeds and restricted tilt above freelif
14. Emergency stop button
15. Side-stance operator compartment with low step height
16. Anti-fatigue cushioned floor mat
17. Back and armrest padding
18. Integrated clipboard and amenity tray
19. Multi-function control handle
20. On-demand priority hydraulic power steering with tiller control
21. Four mode regenerative braking
22. Auto-applied parking brake with anti-rollback feature
23. Four-piece reinforced overhead guard—designed for use with drive-in racking*
24. Battery compartment rollers and gates
25. Large 18" diameter poly drive tires with anti-static ground strap

Optional Equipment

1. Standard or polished and tapered forks in a variety of lengths
2. Side shifters, auxiliary hydraulics or 4-spool valve
3. Single or dual IHR
4. Micro siped poly tires
5. Battery gate interlock switch
6. Front LED headlights
7. Rear LED work light
8. Strobe light
9. Fire extinguisher
10. Freezer package for environments as low as -20°F (-29°C)
11. Low overhead guard (83.3")
12. Operator knee pad
13. Reverse steering
14. Travel alarms
15. Tilt cylinder boots
16. Operator light and fan

Enhanced Operator Comfort & Productivity

The Platinum SCX Series offers a variety of operator conveniences for enhanced comfort and increased productivity. The low step height is ideal for operators whose daily tasks require repeatedly getting on and off the truck throughout the shift. The operator compartment's side stance design provides for comfortable forward or reverse driving, and includes a gently sloped floorboard, providing a relaxed driving position.

The SCX Series offers uniquely comfortable driving due to its floorboard design, which floats on vibration isolators, effectively dampening the effects of riding over dock plates or floor joints. Also included is an anti-fatigue cushioned floor mat for a smoother, more comfortable ride.

The operator platform includes a dual-pedal system—with brake release pedal on the left and an operator presence pedal on the right. Operator comfort is enhanced with thick padding located beneath the operator's arm, back and hip, and with an optional cushion for knees and legs.

Nissan's ergonomically designed multifunction control handle offers simultaneous control of drive, lift and lower, as well as horn and auxiliary hydraulic functions. The tiller controlled, AC powered, on-demand hydraulic power steering system reduces operator effort, for easier maneuvering.

The LCD dash display visibly communicates truck status and warnings for operator awareness including: travel speed, battery capacity, hour meter, brake warning, operator presence warning, and selected power mode.

Wide canopy channels and an angled front crossbar produce greater visibility at higher lift heights, for increased operator confidence and improved productivity. Low front profile offers enhanced fork tip visibility.

The SCX Series' standard safety features include: Return-to-Neutral and Mast Lock (automatically locking mast lift and tilt) when the operator presence pedal is released, Turn Control (automatic restriction of travel speed and acceleration during turning), Lift Control (restricting lift speed at faster travel speeds), and Controlled

Rollback with Ramp Hold (reducing and stopping truck movement down a gradient).

Controllability enhancements above free lift include: reduced traction and lift speed, reduced tilt speed and angle, vertical tilt stop with override, reduced sideshift speed, and reduced regenerative braking force.

Features for Increased Efficiency

The SCX Series' highly reliable CANBus network constantly monitors the commands that the operator sends, responding instantly at extremely efficient levels, resulting in less battery energy being consumed, while achieving greater performance. The adjustable auto-power off system shuts off truck power after 15 minutes of non-operation.

Battery and Electrical

Available with a 36-volt electrical system, the IP65 rated motor controllers feature transistorized power inverters for DC to three phase AC power conversion. The single contactor design reduces maintenance. An emergency stop/power disconnect button shuts off truck power in case of an emergency.

Brake System

Adjustable regenerative braking brings the truck to a smooth, controlled stop, when the foot brake is released, the direction lever is in neutral, or while plugging. The disc brakes are applied automatically when the truck travel speed is zero and no direction command has been given. The spring applied/electronic released disc brakes are mounted directly to the drive motors, with no brake cylinders or hydraulic brake fluids.

Truck and Mast Design

The SCX Series' rugged frame design features a contoured, rounded design for enhanced maneuverability. The four-piece reinforced overhead guard design allows easy replacement should individual components become damaged.

Nissan's flat face mast design features rolled steel channels, large cross sections, and thick inner rails for increased capacity retention. Side thrust rollers on the fork carriage are easily accessed for carriage adjustment.

Drive Unit

Dual front wheel drive provides excellent traction and braking power.

Rugged dual AC drive motors offer more power and quicker response. The SCX Series' individually controlled, AC powered, drive motors mean power is transferred to each motor independently, depending upon turn angle input. For tighter turns, the inner wheel counter-rotates allowing greater maneuverability.

Hydraulics

Powerful AC hydraulic pump motor powers lift and tilt operations, as well as the on-demand power steering system. An electro-proportional hydraulic valve allows smooth feathering and precise control, for improved load handling.

Reduced Maintenance

The Platinum SCX Series features a 100% AC-powered system, including dual brushless drive motors and a brushless hydraulic pump motor. On-demand steering, achieved through a priority hydraulic load sensing valve, eliminates the use of a separate steer motor. The design greatly reduces the number of serviceable parts, including commutators, contactors, and brushes; eliminating expenses related to inspection and replacement of these items, for lower overall operating costs.

The SCX controller includes a built-in test-equipment module with on-board diagnostics and coded service history, logged by hour meter reading. The smart LCD meter panel offers an intuitive on-board diagnostics display, and access to the truck's service history, making troubleshooting faster and easier, for less downtime and more productive working hours. Because all of this can be accomplished directly from the meter panel, no hand-held device or system is required.

As a safeguard, all motors and controllers have thermal protection as standard. In the event that overheating occurs, an LED will warn the operator, and the truck's performance level will automatically be reduced—allowing the operator to complete his or her task before returning to the service area for further cool-down.

When scheduled maintenance is required, the SCX provides exceptional access through its top and front panels.

*Verify mast design and width for use in applications with drive-in racking



ISO 14001:2004
NISSAN GREEN PROGRAM

Nissan Forklift Corporation reserves the right to make product changes relating to colors, equipment, specifications or available options without notice. For more information, contact your Nissan Forklift representative.

NISSAN FORKLIFT

NISSAN
FORKLIFT

Platinum QX Series

Pneumatic Tire / 80 Volt / 4-Wheel **AC-Powered Models**

4,000 - 6,000 lb.
Capacities



Platinum QX series

Dimensions

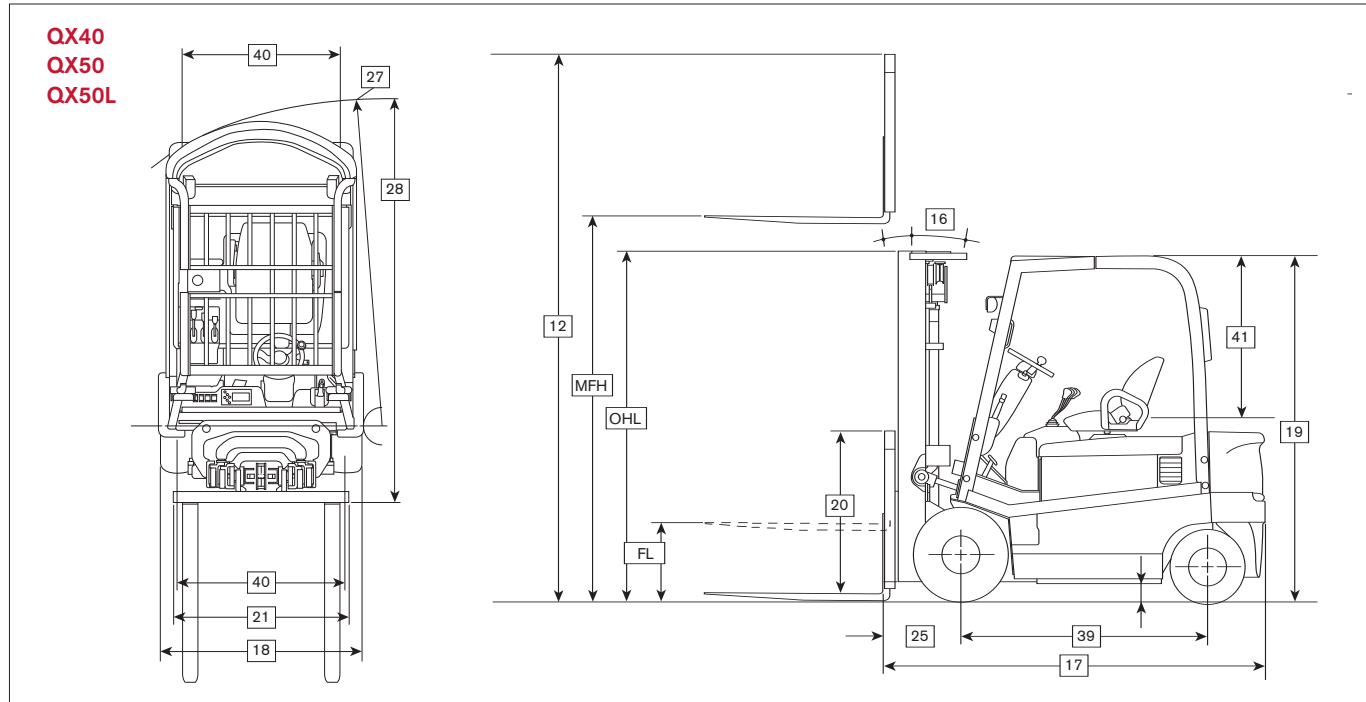

Mast Specifications & Rated Capacities

QX40 QX50 QX50L	Mast Name	Max. Fork Height	Overall Height		Free Lift		Tilt Angle	Rated Capacity at 24" Load Center		
			Lowered	Fully Extended	FL			QX40	QX50 QX50L	
			MFH	OHL	With LBR	Without LBR				With LBR
in	in	in	in	in	in	deg	lb.	lb.		
TWO STAGE (Wide View 2W)	2W300	118	78.6	166.2	143.6	5.9	5.9	5/8	4000	5000
	2W330	130	84.5	178.0	155.4	5.9	5.9	5/8	4000	5000
	2W350	138	89.8	185.9	163.2	5.9	5.9	5/8	4000	5000
	2W370	146	94.7	193.8	171.1	5.9	5.9	5/8	4000	5000
	2W400	157	102.2	205.6	182.9	5.9	5.9	5/8	4000	5000
	2W450	177	112.1	225.2	202.6	5.9	5.9	5/8	4000	5000
	2W500	197	121.9	244.9	222.3	5.9	5.9	5/8	3900	4800
TWO STAGE (Full Free 2F)	2F300	118	78.6	166.2	144.9	32.0	53.3	5/8	4000	5000
	2F330	130	84.5	178.0	156.7	37.9	59.2	5/8	4000	5000
	2F350	138	89.8	185.9	164.6	43.3	64.5	5/8	4000	5000
	2F370	146	94.7	193.8	172.5	48.2	69.4	5/8	4000	5000
	2F400	157	102.2	205.6	184.3	55.7	76.9	5/8	4000	5000
THREE STAGE (Full Free 3F)	3F385	152	72.7	199.7	178.4	26.1	47.6	5/5	4000	5000
	3F430	169	78.6	217.4	196.1	32.0	53.5	5/5	4000	5000
	3F475	187	84.5	235.1	213.8	37.9	59.4	5/5	4000	5000
	3F515	203	89.8	250.8	229.6	43.3	64.7	5/5	3800	4600
	3F550	217	94.7	264.6	243.4	48.2	69.6	5/5	3600	4200
	3F600	236	102.2	284.3	263.0	55.7	77.1	5/5	3100	3400
	3F650	256	112.1	304.0	282.7	65.5	87.0	5/5	2500	2700
	3F700	276	121.9	323.7	302.4	75.3	96.8	5/5	2000	2200

4,000 / 5,000 lb. capacities

Main Truck Specifications

CHARACTERISTICS	1	Manufacturer's Name		Nissan	Nissan	Nissan	1	
	2	Model	Model designation	QX40	QX50	QX50L	2	
	3		Long model code	1Q2L20V	1Q2L25V	G1Q2L25V	3	
	4	Rated Load Capacity		lb (kg)	4000 (1815)	5000 (2265)	5000 (2265)	4
	5	Load Center	Distance	in (mm)	24 (600)	24 (600)	24 (600)	5
	6	Power Type	Electric	voltage	80v	80v	80v	6
	7	Operator Orientation			Sit	Sit	Sit	7
DIMENSIONS	8	Tire Type	Front & rear		Solid Pneumatic	Solid Pneumatic	Solid Pneumatic	8
	9	Wheels	Number - front/rear (x=driven)		2x / 2	2x / 2	2x / 2	9
	10	Mast	Maximum fork height	in (mm)	130 (3300)	130 (3300)	130 (3300)	10
	11		Mast lowered (OHL)	in (mm)	84.5 (2145)	84.5 (2145)	84.5 (2145)	11
	12		Mast extended with LBR	in (mm)	178 (4520)	178 (4520)	178 (4520)	12
	13		Standard freelif with LBR	in (mm)	5.9 (150)	5.9 (150)	5.9 (150)	13
	14	Forks	Thickness & width	in (mm)	1.5 x 4 (40x100)	1.5 x 4 (40x100)	1.5 x 4 (40x100)	14
	15		Length (STD)	in (mm)	42.1 (1070)	42.1 (1070)	42.1 (1070)	15
	16	Tilt Angle	Standard mast - fwd/back	degree	5 / 8	5 / 8	5 / 8	16
	17	Overall Dimensions	Length (to face of forks)	in (mm)	92.1 (2340)	92.1 (2340)	97.8 (2485)	17
	18		Width (standard tires)	in (mm)	46.5 (1180)	46.5 (1180)	46.5 (1180)	18
	19		Height - top of OHG	in (mm)	88 (2235)	88 (2235)	88 (2235)	19
	20		Height - top of standard LBR	in (mm)	48 (1220)	48 (1220)	48 (1220)	20
	21		Width - standard carriage	in (mm)	40.2 (1020)	40.2 (1020)	40.2 (1020)	21
	22	Grade Clearance	Approach angle	tanθ(%)	31	31	31	22
	23		Ramp breakover angle	tanθ(%)	29	29	26	23
	24		Departure angle	tanθ(%)	44	44	44	24
	25	Overhang	Front	in (mm)	18.3 (465)	18.3 (465)	18.3 (465)	25
	26		Rear	in (mm)	14.2 (360)	14.2 (360)	14.2 (360)	26
	27	Turning Radius	Minimum outside	in (mm)	78.4 (1990)	78.4 (1990)	84.3 (2140)	27
	28	Min Right Angle Stack	Add load length & clearance	in (mm)	96.7 (2455)	96.7 (2455)	102.6 (2605)	28
WEIGHT PERFORMANCE	29	Speeds Maximum	Travel - loaded / unloaded	mph (km/h)	12.7 (20.5) / 13.0 (21.0)	12.4 (20.0) / 13.0 (21.0)	12.4 (20.0) / 13.0 (21.0)	29
	30		Lift - loaded / unloaded	fpm (mm/sec)	100.4 (510) / 127.9 (650)	92.5 (470) / 127.9 (650)	92.5 (470) / 127.9 (650)	30
	31		Lowering - loaded / unloaded	fpm (mm/sec)	98.4 (500) / 98.4 (500)	98.4 (500) / 98.4 (500)	98.4 (500) / 98.4 (500)	31
	32	Drawbar Pull Maximum	Full load, 5 minute rating	lb (N)	2811 (12503)	2811 (12503)	2811 (12503)	32
	33	Gradeability Maximum	Full load, 5 minute rating	tanθ(%)	19	16	16	33
CHASSIS & WHEELS	34	Truck Weight	Empty, min. battery	lb (kg)	9705 (4400)	10445 (4735)	10575 (4795)	34
	35	Weight Distribution	Full load front/rear - min. battery	lb (kg)	11980 (5435) / 1725 (780)	13610 (6175) / 1835 (830)	13790 (6255) / 1785 (810)	35
	36		No load front/rear - min. battery	lb (kg)	5140 (2330) / 4565 (2070)	5060 (2295) / 5385 (2440)	5545 (2515) / 5030 (2280)	36
	37	Tire Size	Front	in	23 x 9 - 10	23 x 9 - 10	23 x 9 - 10	37
	38		Rear	in	18 x 7 - 8	18 x 7 - 8	18 x 7 - 8	38
	39	Wheelbase		in (mm)	59.6 (1515)	59.6 (1515)	65.4 (1660)	39
	40	Tread - Center of Tire	Front / rear (standard tires)	in (mm)	38.4 (975) / 38.2 (970)	38.4 (975) / 38.2 (970)	38.4 (975) / 38.2 (970)	40
	41	Headroom	SIP to bottom of OHG	in (mm)	41.1 (1045)	41.1 (1045)	41.1 (1045)	41
	42	Counterweight Height		in (mm)	40.9 (1040)	40.9 (1040)	40.9 (1040)	42
	43	Step Height		in (mm)	13.5 (345)	13.5 (345)	13.5 (345)	43
	44	Ground Clearance	Under mast	in (mm)	4.5 (115)	4.5 (115)	4.5 (115)	44
	45		Under frame, center of wheelbase	in (mm)	4.1 (105)	4.1 (105)	4.1 (105)	45
	46	Service Brake	Type		Elec / Hyd	Elec / Hyd	Elec / Hyd	46
47	Parking Brake	Actuation Type		Hand	Hand	Hand	47	
DRIVE LINE	48	Steering	On-demand		Hydraulic	Hydraulic	Hydraulic	48
	49	Traction Motor	Type / Rating (1 hour)	kW	AC / 9.9	AC / 9.9	AC / 9.9	49
	50		Control type		MOS-FET Inverter	MOS-FET Inverter	MOS-FET Inverter	50
51	Pump Motor	Type / Rating (5-min.)	kW	AC / 21.5	AC / 21.5	AC / 21.5	51	
BATTERY	52	Battery Compartment Size	W x H - Maximum	in (mm)	40.66 x 31.65 (1033 x 804)		40.66 x 31.65 (1033 x 804)	52
	53		L - Maximum	in (mm)	28.18 (716)		33.85 (860)	53
	54	Recommended Battery Size	W x H	in (mm)	40.35 x 30.86 (1025 x 784)		40.35 x 30.86 (1025 x 784)	54
	55		L	in (mm)	27.87 (708)		33.54 (852)	55
	56		Lead acid	Type (DIN)	40-125-09 (40 - 4 PzS 620)		40-140-09 (40 - 5 PzS 775)	56
	57	Capacity	Minimum / Maximum	Ah/5h	480 / 620		600 / 775	57
	58	Weight	Minimum / Maximum	lb (kg)	3240 / 3595 (1470 / 1630)		3900 / 4345 (1770 / 1970)	58
	59	Lead Length	Position A	in (mm)	15.8 (400)		15.8 (400)	59
	60	Connector		Type	SBE320 Black		SBE320 Black	60

Platinum QX series

Dimensions

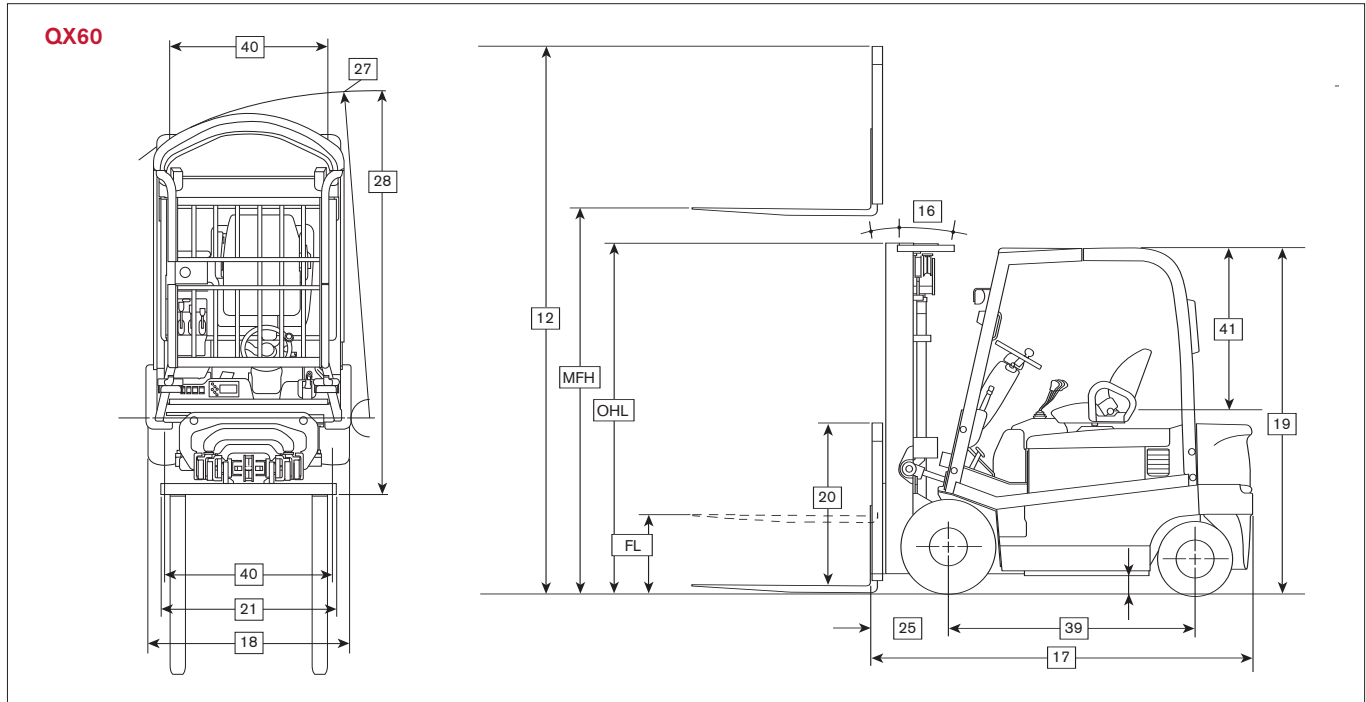

Mast Specifications & Rated Capacities

QX60	Mast Name	Max. Fork Height	Overall Height		Free Lift		Tilt Angle	Rated Capacity at 24" Load Center	
			Lowered	Fully Extended	FL				
			MFH	OHL	With LBR	Without LBR	With LBR	Without LBR	Fwd/Bkwd deg
in	in	in	in	in	in	deg	lb.		
TWO STAGE (Wide View 2W)	2W300	118	78.6	166.2	143.6	6.2	6.2	5/8	6000
	2W330	130	84.5	178.0	155.4	6.2	6.2	5/8	6000
	2W350	138	89.8	185.9	163.2	6.2	6.2	5/8	6000
	2W370	146	94.7	193.8	171.1	6.2	6.2	5/8	6000
	2W400	157	102.2	205.6	182.9	6.2	6.2	5/8	6000
	2W450	177	112.1	225.2	202.6	6.2	6.2	5/8	5900
	2W500	197	121.9	244.9	222.3	6.2	6.2	5/8	5600
TWO STAGE (Full Free 2F)	2F300	118	78.6	166.2	144.9	32.4	53.9	5/8	6000
	2F330	130	84.5	178.0	157.1	38.3	59.8	5/8	6000
	2F350	138	89.8	185.9	164.6	43.7	65.1	5/8	6000
	2F370	146	94.7	193.8	172.5	48.6	70.0	5/8	6000
	2F400	157	102.2	205.6	184.3	56.1	77.5	5/8	6000
THREE STAGE (Full Free 3F)	3F385	152	78.6	199.7	176.4	32.4	55.7	5/5	6000
	3F430	169	84.5	217.4	194.1	38.3	61.6	5/5	6000
	3F475	187	89.8	235.1	211.9	43.7	66.9	5/5	5700
	3F515	203	94.7	250.8	227.6	48.6	71.8	5/5	5500
	3F550	217	102.2	264.6	241.4	56.1	79.3	5/5	4800
	3F600	236	112.1	284.3	261.1	65.9	89.1	5/5	4100
	3F650	256	121.9	304.0	280.8	75.7	99.0	5/5	3500
	3F700	276	131.7	323.7	300.4	85.6	108.8	5/5	2800

6,000 lb. capacity

Main Truck Specifications

CHARACTERISTICS	1	Manufacturer's Name		Nissan	1	
	2	Model	Model designation	QX60	2	
	3		Long model code	G1Q2L30V	3	
	4	Rated Load Capacity		lb (kg)	6000 (2720)	4
	5	Load Center	Distance	in (mm)	24 (600)	5
	6	Power Type	Electric	voltage	80v	6
	7	Operator Orientation			Sit	7
DIMENSIONS	8	Tire Type	Front & rear		Solid Pneumatic	8
	9	Wheels	Number - front/rear (x=driven)		2x / 2	9
	10	Mast	Maximum fork height	in (mm)	130 (3300)	10
	11		Mast lowered (OHL)	in (mm)	84.5 (2145)	11
	12		Mast extended with LBR	in (mm)	178 (4520)	12
	13		Standard freelif with LBR	in (mm)	6.2 (160)	13
	14	Forks	Thickness & width	in (mm)	2 x 5 (50x125)	14
	15		Length (STD)	in (mm)	42.1 (1070)	15
	16	Tilt Angle	Standard mast - fwd/back	degree	5 / 8	16
	17	Overall Dimensions	Length (to face of forks)	in (mm)	98.2 (2495)	17
	18		Width (standard tires)	in (mm)	49.2 (1250)	18
	19		Height - top of OHG	in (mm)	88 (2235)	19
	20		Height - top of standard LBR	in (mm)	48 (1220)	20
	21		Width - standard carriage	in (mm)	40.2 (1020)	21
	22	Grade Clearance	Approach angle	tanθ(%)	31	22
	23		Ramp breakover angle	tanθ(%)	26	23
	24		Departure angle	tanθ(%)	44	24
	25	Overhang	Front	in (mm)	18.7 (475)	25
	26		Rear	in (mm)	14.2 (360)	26
	27	Turning Radius	Minimum outside	in (mm)	84.3 (2140)	27
	28	Min Right Angle Stack	Add load length & clearance	in (mm)	103.0 (2615)	28
WEIGHT PERFORMANCE	29	Speeds Maximum	Travel - loaded / unloaded	mph (km/h)	11.5 (18.5) / 13.0 (21.0)	29
	30		Lift - loaded / unloaded	fpm (mm/sec)	88.6 (450) / 108.3 (550)	30
	31		Lowering - loaded / unloaded	fpm (mm/sec)	98.4 (500) / 98.4 (500)	31
	32	Drawbar Pull Maximum	Full load, 5 minute rating	lb (N)	2733 (12155)	32
	33	Gradeability Maximum	Full load, 5 minute rating	tanθ(%)	14	33
	34	Truck Weight	Empty, min. battery	lb (kg)	11460 (5200)	34
35	Weight Distribution	Full load front/rear - min. battery	lb (kg)	15575 (7065) / 1885 (855)	35	
		No load front/rear - min. battery	lb (kg)	5650 (2565) / 5810 (2635)	36	
CHASSIS & WHEELS	37	Tire Size	Front	in	23 x 10 - 12	37
	38		Rear	in	18 x 7 - 8	38
	39	Wheelbase		in (mm)	65.4 (1660)	39
	40	Tread - Center of Tire	Front / rear (standard tires)	in (mm)	40.0 (1015) / 38.2 (970)	40
	41	Headroom	SIP to bottom of OHG	in (mm)	41.1 (1045)	41
	42	Counterweight Height		in (mm)	40.9 (1040)	42
	43	Step Height		in (mm)	13.5 (345)	43
	44	Ground Clearance	Under mast	in (mm)	4.5 (115)	44
			Under frame, center of wheelbase	in (mm)	4.1 (105)	45
	46	Service Brake	Type		Elec / Hyd	46
47	Parking Brake	Actuation Type		Hand	47	
DRIVE LINE	48	Steering	On-demand		Hydraulic	48
	49	Traction Motor	Type / Rating (1 hour)	kW	AC / 9.9	49
			Control type		MOS-FET Inverter	50
51	Pump Motor	Type Rating (5-min.)	kW	AC / 21.5	51	
BATTERY	52	Battery Compartment Size	W x H - Maximum	in (mm)	40.66 x 31.65 (1033 x 804)	52
	53		L - Maximum	in (mm)	33.85 (860)	53
	54	Recommended Battery Size	W x H	in (mm)	40.35 x 30.86 (1025 x 784)	54
			L	in (mm)	33.54 (852)	55
	56		Lead acid	Type (DIN)	40-140-09 (40 - 5 PzS 775)	56
	57	Capacity	Minimum / Maximum	Ah/5h	600 / 775	57
	58	Weight	Minimum / Maximum	lb (kg)	3900 / 4345 (1770 / 1970)	58
	59	Lead Length	Position A	in (mm)	15.8 (400)	59
	60	Connector		Type	SBE320 Black	60

Technical Information

Standard Equipment

1. 80 Volt, brushless, AC drive motor and AC pump motor
2. Nissan AC TECH controller with built-in test equipment and multi-function LCD display
3. Multi-function LCD display with:
 - BDI with lift interrupt
 - Hour meters (4)
 - Speedometer
 - Clock
4. On-board diagnostics, self-test and coded service history
5. Three, pre-set performance mode settings—economy, normal and high, plus a manual setting
6. Secure, PIN access to personalized performance settings
7. Load sensing, on-demand hydraulic power steering
8. Flex-logic acceleration control
9. Five-mode regenerative braking
10. Nissan's Operator Presence System includes seat-actuated power interrupt system, seat belt warning buzzer and parking brake warning buzzer
11. Audible back-up warning alarm
12. Controlled rollback feature restricts truck descent speed down an incline
13. Deck mounted, separate lift/tilt hydraulic control levers, with 3-spool valve
14. Full suspension vinyl seat with operator restraint system and seat belt warning
15. Infinitely adjustable steering column
16. Small diameter steering wheel with knob
17. Overhead guard mounted headlights

18. Five-piece reinforced overhead guard
19. Solid pneumatic tires
20. Rearview mirrors
21. Turn, stop and backup lights
22. Rear work light

Optional Equipment

1. Standard, or polished and tapered, forks in a variety of lengths
2. Side shifters with auxiliary hydraulics, valving, and levers
3. Single, or dual, IHR for all mast types
4. Fingertip control levers with single or separate lift/tilt control levers
5. Auto tilt leveling
6. Smooth run system (fully integrated double hydraulic accumulators)
7. Wide or non-marking solid pneumatic tires
8. Steering synchronizer (knob position control)
9. Strobe light
10. Fire extinguisher
11. Magnetic convenience tray
12. Freezer package for environments as low as -31°F (-35°C)
13. Polycarbonate overhead guard cover

Ergonomics & Operator Comfort

The QX Series offers a variety of operator conveniences for enhanced comfort and increased productivity, including a full suspension vinyl seat with weight and back-angle adjustment, hip restraints and retractable seat belt. A compact front cowl design offers generous foot and leg room, along with a wide entry

step. Its infinitely adjustable steering column enhances operator comfort.

The QX Series' AC TECH controller offers Flex-logic acceleration control which enables the truck to respond according to the speed with which the acceleration pedal is depressed, allowing more accurate, precise control by the driver. The hydraulic steering system reduces operator effort, for easier maneuvering.

Automotive-style light and turn signal levers simplify repetitive actions allowing the operator to focus on the job. An optional auto tilt leveling system assists proper mast/fork positioning.

Dual lift and tilt lever, deck-mounted hydraulic controls are standard. An adjustable armrest with fingertip control hydraulics can be ordered as an option, and is available with Nissan's exclusive single lift/tilt design, resulting in enhanced ergonomics, and further improving productivity.

The LCD dash display visibly communicates truck status and warnings for operator awareness including: travel speed, battery capacity, hour meter (4-mode), time and day of week, brake warning, seat belt warning, and selected power mode.

The QX Series' Operator Presence System, with seat-actuated power interrupt, incorporates a mast-lock which automatically locks lift and tilt operations when the operator leaves the seat, and a return-to-neutral feature to minimize forklift movement if the operator leaves the seat while the lift truck is still in gear. This presence system also includes audible and visual warnings if either the seat belt is not engaged while in travel mode, or when the parking brake has not been applied prior to the operator exiting the compartment.

Technical Information

Efficient Performance

Powerful 80-volt motors deliver increased performance and similar productivity to engine-powered trucks, providing customers an emissions-free alternative to combustion trucks with comparable performance.

The QX Series' AC TECH controller provides lower battery consumption and optimum operating efficiencies through regenerative braking, automatic deceleration, and on-demand power steering. Five-mode regenerative braking system increases the number of working hours per battery charge. An adjustable auto-power off feature switches off the electrical system if the truck sits idle for a preprogrammed time period.

A four-digit PIN code offers access to customized performance settings, allowing up to five unique operational profiles according to driver experience and load handling conditions. Or, select from three preset performance modes (economy, normal, high) based on the application. If additional flexibility is needed, settings can be adjusted manually to meet application needs.

The QX Series' highly reliable CAN-Bus network constantly monitors the commands that the operator sends, responding instantly at extremely efficient levels, resulting in less battery energy being consumed, while achieving greater performance.

Motor and controller feature thermal protection system to slow or shut down truck in response to high temperatures.

Battery and Electrical

With an 80-volt electrical system, the AC TECH motor controller features transistorized power inverters, for DC to three

phase AC power conversion. The single contactor design reduces maintenance. An emergency stop/power disconnect button shuts off truck power in case of an emergency.

Truck and Mast Design

The QX Series' rugged, unitized frame design incorporates an integral hydraulic tank for better heat dissipation, increased durability, and longer life. Contoured counterweight design enhances maneuverability.

Five-piece reinforced overhead guard design allows easy replacement should individual parts become damaged. Slotted design facilitates overhead battery replacement.

Nissan's flat face mast design features rolled steel channels, large cross sections, and thick inner rails for increased capacity retention. Side thrust rollers on the fork carriage are easily accessed for carriage adjustment.

Drive Unit

Free floating drive axle with lateral mounted AC drive motor offers more power and quicker response. Quieter, more efficient helical gearing reduces noise levels and increases durability. Service brakes are standard shoe type.

Solid Pneumatic Tires

Solid pneumatic tires absorb vibration for a smoother ride over rough surfaces.

Hydraulics

Powerful AC hydraulic pump motor powers lift and tilt operation as well as the on-demand power steering system. Hydraulic operation is infinitely variable through the AC TECH controller.

Hydraulic oil tank filler location makes daily level checks and periodic refills fast and simple.

Steer System

On-demand steering is achieved through a priority hydraulic load sensing valve, which diverts fluid as needed to either the mast functions or steering system, with priority to steering, eliminating the need for a separate steering motor.

Brake System

Automatic, programmable regenerative deceleration prolongs brake life. Regenerative braking is achieved through switch-back/plugging, foot applied braking, neutral braking, and controlled roll back.

Reduced height brake pedal improves the ease of operation and reduces operator fatigue. A hand-actuated parking brake, with lock release button is located on the cowl within easy reach.

Ease of Maintenance

The QX Series features a 100% AC-powered system, including brushless drive motor and hydraulic pump motor. AC motors use fewer components and require less maintenance, for lower operating costs. The design greatly reduces the number of serviceable parts, including commutators, contactors, and brushes; eliminating expenses related to inspection and replacement of these items, for lower overall operating costs.

The AC TECH controller includes a built-in-test-equipment module with self-diagnostics and coded service history, logged by hour meter reading. Troubleshooting through the meter panel allows rapid access to service requirements. No additional handset tool is required.

Option Availability

Platinum QX Series

Standard S Option O

Vehicle Management	Vehicle Control Module (VCM)	S
	Multi-function LCD meter panel display:	S
	Battery discharge indicator with lift interrupt	S
	Hour meter	S
	Speedometer	S
	Security PIN access	S
	3+1 Performance modes	S
	Clock	S
	On-board diagnostics & troubleshooting	S
	Auto power shutoff	S
	Controlled rollback	S
	CAN-bus communication	S
	Motor and controller thermal protection	S
Powertrain	80-volt electrical system	S
	Brushless, AC drive motor	S
	AC TECH motor controller	S
	Flex-logic acceleration control	S
	Full floating, helical and hypoid gears	S
	Solid pneumatic tires	S
Non-marking, solid pneumatic tires	O	
Operator Presence System	Seat actuated, auto-mast lock system	S
	Automatic return-to-neutral	S
	Seatbelt warning	S
Steering System	Tilt steering wheel	S
	On-demand, hydrostatic power steering system	S
	Small diameter steering wheel	S
	Synchronized steering (knob position control)	O
	Steering wheel spinner knob	O
Brake	5-mode regenerative braking system	S
	Parking brake with warning	S
Hydraulic System	Brushless, AC hydraulic pump motor	S
	Low noise, zero backlash pump	S
	Deck mounted hydraulic control levers	S
	Separate lift & tilt control levers	S
	Fingertip control with single lift/tilt control lever	O
	Fingertip control with separate lift & tilt levers	O
	Auto-tilt leveling system	O
Operator Conveniences	Full suspension vinyl seat	S
	OHG-mounted headlights	S
	Cushioned floor mat	S
	Back-up alarm	S
	Rear combination lights with front turn signals	S
	Rear work light	S
	Rearview mirrors	S
	Strobe light or rotating beacon	O
	Full suspension cloth seat	O

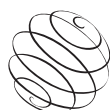

Nissan Forklift Corporation reserves the right to make product changes relating to colors, equipment, specifications or available options without notice. For more information, contact your Nissan Forklift representative.

NISSAN
FORKLIFT

NISSAN
FORKLIFT

Platinum BX Series

Cushion Tire / 36 & 48 Volt / 4-Wheel AC-Powered Models

3,000 - 8,000 lb.
Capacities



Platinum BX_{series}

Dimensions

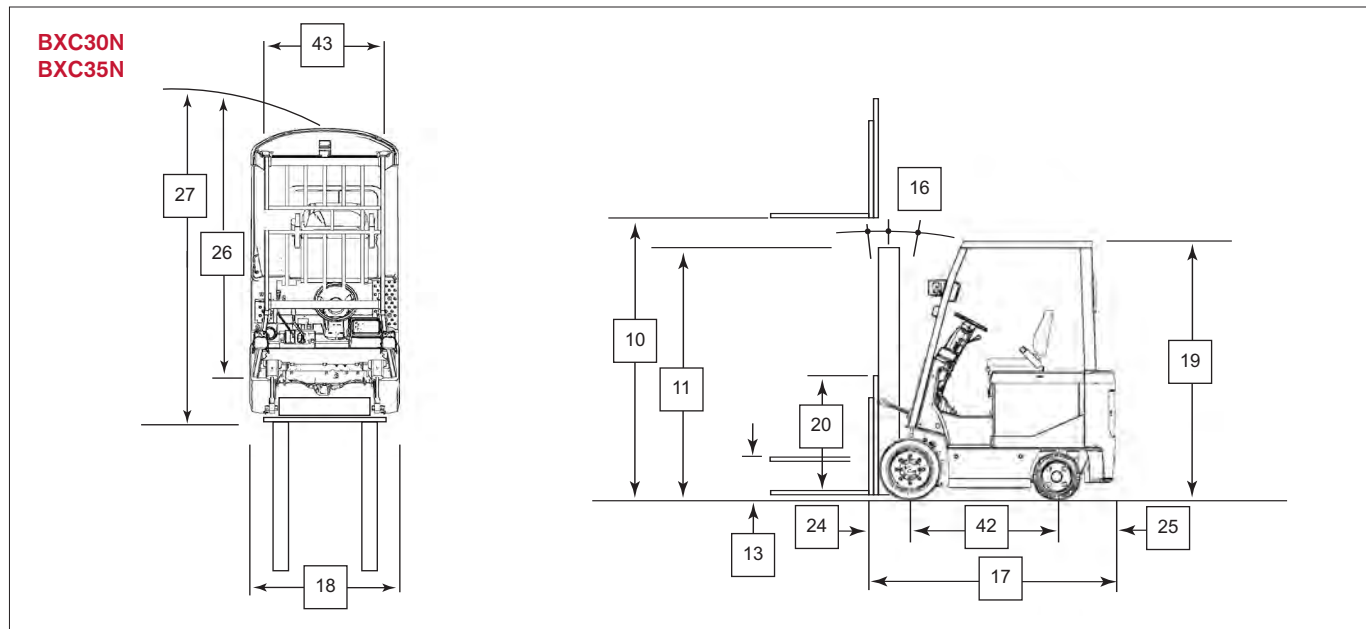

Mast Specifications & Rated Capacities

	Mast Name	Maximum Fork Height	Overall Height Lowered	Free Lift*	Tilt angle Forward/Backward	Rated Capacity at 24" Load Center	
						BXC30N	BXC35N
TWO STAGE (Wide view 2W)	2W270	106	71.1	3.9	5/10	3000	3500
	2W300	118	77.0	3.9	5/10	3000	3500
	2W330	130	82.9	3.9	5/10	3000	3500
	2W350	138	88.2	3.9	5/10	3000	3500
	2W370	146	93.1	3.9	5/10	3000	3500
	2W400	157	100.6	3.9	5/10	3000	3200
	2W450	177	110.4	3.9	5/5	2850	3000
	2W500	197	120.3	3.9	5/5	2500	2600
TWO STAGE (Full free 2F)	2F300	118	77.0	53.0	5/10	3000	3500
	2F330	130	82.9	58.9	5/10	3000	3500
	2F350	138	88.2	64.2	5/10	3000	3500
	2F370	146	93.1	69.1	5/10	3000	3500
	2F400	157	100.6	76.6	5/10	3000	3200
THREE STAGE (Full free 3F)	3F385	152	71.1	48.4	5/5	3000	3500
	3F430	169	77.0	54.3	5/5	2800	3300
	3F475	187	82.9	60.2	5/5	2600	2700
	3F515	203	88.2	65.6	5/5	2400	2500
	3F550	217	93.1	70.5	5/5	2200	2300
	3F600	236	100.6	78.0	5/5	1700	1800
THREE STAGE (OptiView 3V)	3V360	142	71.1	49.2	5/5	2850	3350
	3V405	159	77.0	55.1	5/5	2750	3200
	3V450	177	82.9	61.0	5/5	2650	2900
	3V490	193	88.2	66.3	5/5	2500	2650
	3V525	207	93.1	71.3	5/5	2350	2450
	3V575	226	100.6	78.7	5/5	1950	2050

* Without backrest

3,000 / 3,500 lb. capacities

Main Truck Specifications

CHARACTERISTICS				Nissan Forklift		Nissan Forklift		
1	Manufacturer's Name			Nissan Forklift		Nissan Forklift		1
2	Model	Model designation		BXC30N		BXC35N		2
3		Long model code		MCJ1B1L15S		MCJ1B1L18S		3
4	Rated Load Capacity		lb (kg)	3000 (1500)		3500 (1750)		4
5	Load Center	Distance	in (mm)	24 (500)		24 (500)		5
6	Power Type	Electric	voltage	36v	48v	36v	48v	6
7	Operator Orientation			Sit		Sit		7
8	Tire Type	Front & rear		Cushion		Cushion		8
9	Wheels	Number - front/rear (x=driven)		2x / 2		2x / 2		9
10	Mast	Maximum fork height	in (mm)	130 (3300)		130 (3300)		10
11		Mast lowered (OHL)	in (mm)	82.9 (2106)		82.9 (2106)		11
12		Mast extended with LBR	in (mm)	179.3 (4555)		179.3 (4555)		12
13		Standard freelif	in (mm)	3.9 (100)		3.9 (100)		13
14	Forks	Thickness & width	in (mm)	1.5 x 4 (40x100)		1.5 x 4 (40x100)		14
15		Length (STD)	in (mm)	42.1 (1070)		42.1 (1070)		15
16	Tilt Angle	Standard mast - fwd/back	degree	5 / 10		5 / 10		16
17	Overall Dimensions	Length (to face of forks)	in (mm)	80.9 (2055)		81.3 (2060)		17
18		Width (standard tires)	in (mm)	38.2 (970)		38.2 (970)		18
19		Height - top of OHG	in (mm)	86.2 (2190)		86.2 (2190)		19
20		Height - top of standard LBR	in (mm)	48.0 (1220)		48.0 (1220)		20
21		Width - standard carriage	in (mm)	32.4 (825)		32.4 (825)		21
22	Grade Clearance	Ramp breakover angle	%	26.0		26.0		22
23		Departure angle	%	36.0		36.0		23
24	Overhang	Front	in (mm)	15.9 (405)		15.9 (405)		24
25		Rear	in (mm)	16.9 (430)		17.1 (435)		25
26	Turning Radius	Minimum outside	in (mm)	70.9 (1800)		70.9 (1800)		26
27	Min Right Angle Stack	Add load length & clearance	in (mm)	86.8 (2205)		86.8 (2205)		27
28	Speeds Maximum	Travel - loaded (36v / 48v)	mph (km/h)	9.0 (14.5)	9.0 (14.5)	9.0 (14.5)	9.0 (14.5)	28
29		Travel - unloaded (36v / 48v)	mph (km/h)	10.6 (17.0)	10.6 (17.0)	10.6 (16.5)	10.3 (16.5)	29
30		Lift - loaded (36v / 48v)	fpm (mm/sec)	66.0 (335)	85.7 (435)	59.1 (300)	76.8 (390)	30
31		Lift - unloaded (36v / 48v)	fpm (mm/sec)	105.3 (535)	126.0 (640)	105.3 (535)	126.0 (640)	31
32		Lowering - loaded	fpm (mm/sec)	98.5 (500)		98.5 (500)		32
33		Lowering - unloaded	fpm (mm/sec)	97.5 (495)		97.5 (495)		33
34	Drawbar Pull Maximum	Full load (36v/48v)	lb (N)	2378 (10580)	2708 (12045)	2378 (10580)	2708 (12045)	34
35	Gradeability Maximum	Full load (36v/48v)	%	20.8	24.0	18.5	21.5	35
37	Truck Weight	Empty, min battery	lb (kg)	6550 (2970)		6945 (3150)		37
38	Weight Distribution	Full load front/rear - min. battery	lb (kg)	8305 / 1245 (3770 / 565)		9135 / 1310 (4145 / 595)		38
39		No load front/rear - min. battery	lb (kg)	2815 / 3735 (1275 / 1695)		2725 / 4220 (1235 / 1915)		39
40	Tire Size	Front	in	18 x 6 x 12-1/8		18 x 6 x 12-1/8		40
41		Rear	in	14 x 5 x 10		14 x 5 x 10		41
42	Wheelbase		in (mm)	48 (1220)		48 (1220)		42
43	Tread - Center of Tire	Front / rear (standard tires)	in (mm)	32.1 / 32.3 (815 / 820)		32.1 / 32.3 (815 / 820)		43
44	Headroom	SIP to bottom of OHG	in (mm)	41.5 (1055)		41.5 (1055)		44
45	Counterweight Height		in (mm)	42.3 (1075)		42.3 (1075)		45
46	Step Height		in (mm)	17.3 (440)		17.3 (440)		46
47	Ground Clearance	Under mast	in (mm)	3.0 (75)		3.0 (75)		47
48		Under power unit	in (mm)	2.3 (60)		2.3 (60)		48
49		Under frame, center of wheelbase	in (mm)	3.1 (80)		3.1 (80)		49
50	Service Brake	Type		Hyd / Elec		Hyd / Elec		50
51	Parking Brake	Type		Pedal		Pedal		51
52	Steering	On-demand		Hydraulic		Hydraulic		52
53	Traction Motor	Type		AC Induction		AC Induction		53
54		Control type		MOS-INV		MOS-INV		54
55		Rating	kW/h	7.0	9.2	7.0	9.2	55
56	Pump Motor	Type		AC Induction		AC Induction		56
57		Rating	kW/5min	8.3	11.3	8.3	11.3	57
58	Required Battery Size	Minimum - W x L	in (mm)	30.12 x 20.87 (765 x 530)		30.12 x 20.87 (765 x 530)		58
59		Minimum - H	in (mm)	21.37 (542)		21.37 (542)		59
60		Maximum - W x L	in (mm)	35.15 x 26.68 (893 x 677)		35.15 x 26.68 (893 x 677)		60
61		Maximum - H	in (mm)	22.81 (579)		22.81 (579)		61
62		Lead acid (36v / 48v)	Type	18-85-19	24-85-15	18-85-19	24-85-15	62
63		Capacity - Minimum (36v / 48v)	Ah/6h	600	450	600	450	63
64		Capacity - Maximum (36v / 48v)	Ah/6h	900	700	900	700	64
65	Weight	Minimum / Maximum	lb (kg)	1840 / 2535 (835 / 1150)		1840 / 2150 (835 / 975)		65
66	Lead Length	Position B	in (mm)	18 (455)		18 (455)		66
67	Connector	Type		SB-350 Gray		SB-350 Gray		67

Platinum BX_{series}

Dimensions

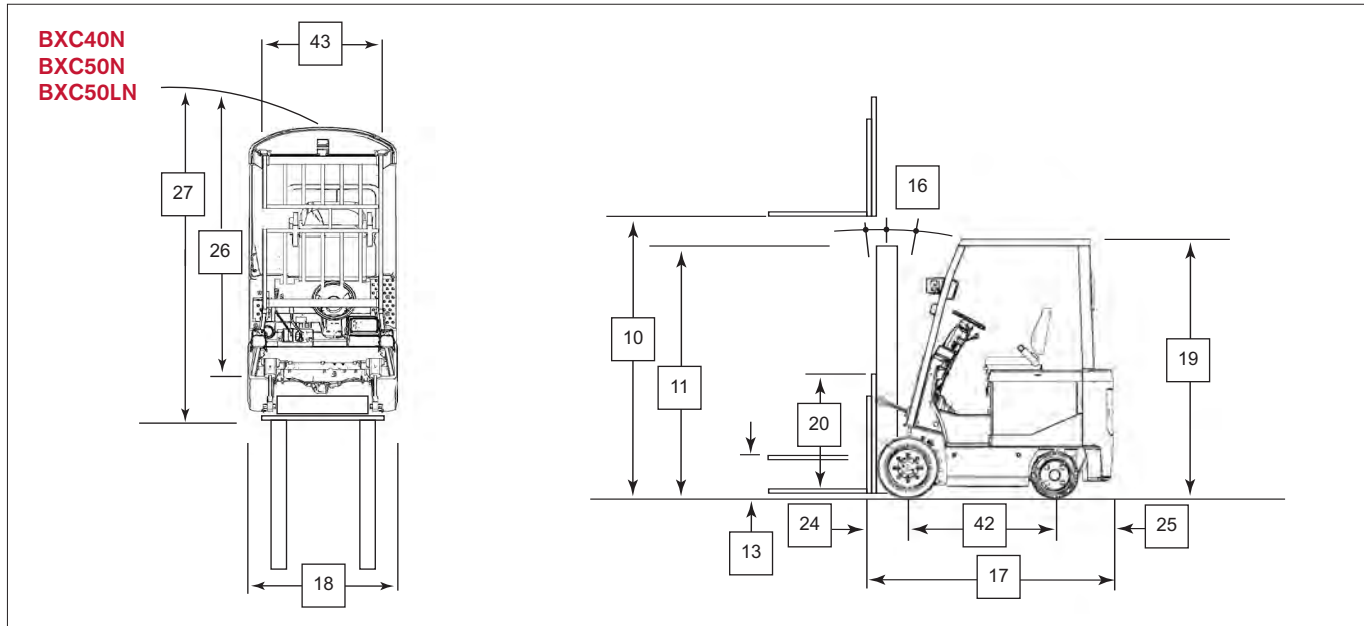

Mast Specifications & Rated Capacities

	Mast Name	Maximum Fork Height	Overall Height Lowered	Free Lift*	Tilt angle Forward/Backward	Rated Capacity at 24" Load Center		
						BXC40N	BXC50N	BXC50LN
TWO STAGE (Wide view 2W)	2W270	106	71.3	4.1	5/10	4000	5000	5000
	2W300	118	77.2	4.1	5/10	4000	5000	5000
	2W330	130	83.1	4.1	5/10	4000	5000	5000
	2W350	138	88.4	4.1	5/10	4000	5000	5000
	2W370	146	93.3	4.1	5/10	4000	5000	5000
	2W400	157	100.8	4.1	5/10	4000	5000	5000
	2W450	177	110.6	4.1	5/5	3800	4850	4850
	2W500	197	120.5	4.1	5/5	3600	3900	3900
TWO STAGE (Full free 2F)	2F300	118	77.2	53.3	5/10	4000	5000	5000
	2F330	130	83.1	59.3	5/10	4000	5000	5000
	2F350	138	88.4	64.6	5/10	4000	5000	5000
	2F370	146	93.3	69.5	5/10	4000	5000	5000
	2F400	157	100.8	77.0	5/10	4000	5000	5000
THREE STAGE (Full free 3F)	3F385	152	71.3	48.4	5/5	4000	5000	5000
	3F430	169	77.2	54.3	5/5	3900	4850	4850
	3F475	187	83.1	60.2	5/5	3700	4700	4700
	3F515	203	88.4	65.6	5/5	3300	4250	4250
	3F550	217	93.3	70.5	5/5	3100	3700	3700
	3F600	236	100.8	78.0	5/5	2300	2900	2900
THREE STAGE (Optiview 3V)	3V360	142	71.3	49.4	5/5	3950	4900	4900
	3V405	159	77.2	55.3	5/5	3800	4750	4750
	3V450	177	83.1	61.2	5/5	3650	4550	4600
	3V490	193	88.4	66.5	5/5	3500	4500	4500
	3V525	207	93.3	71.5	5/5	3250	4100	4100
	3V575	226	100.8	78.9	5/5	2700	3050	3050

*Without backrest

4,000 / 5,000 lb. capacities

Main Truck Specifications

CHARACTERISTICS				Nissan Forklift		Nissan Forklift		Nissan Forklift		
1	Manufacturer's Name			Nissan Forklift		Nissan Forklift		Nissan Forklift		1
2	Model	Model designation		BXC40N		BXC50N		BXC50LN		2
3		Long model code		MCT1B2L20S		MCT1B2L25S		MCTG1B2L25S		3
4	Rated Load Capacity		lb (kg)	4000 (2000)		5000 (2500)		5000 (2500)		4
5	Load Center	Distance	in (mm)	24 (500)		24 (500)		24 (500)		5
6	Power Type	Electric	voltage	36v	48v	36v	48v	36v	48v	6
7	Operator Orientation			Sit		Sit		Sit		7
8	Tire Type	Front & rear		Cushion		Cushion		Cushion		8
9	Wheels	Number - front/rear (x=driven)		2x / 2		2x / 2		2x / 2		9
10	Mast	Maximum fork height	in (mm)	130 (3300)		130 (3300)		130 (3300)		10
11		Mast lowered (OHL)	in (mm)	83.1 (2111)		83.1 (2111)		83.1 (2111)		11
12		Mast extended with LBR	in (mm)	179.3 (4555)		179.3 (4555)		179.3 (4555)		12
13		Standard freelif	in (mm)	4.1 (104)		4.1 (104)		4.1 (104)		13
14	Forks	Thickness & width	in (mm)	1.5 x 4 (40x100)		1.5 x 4 (40x100)		1.5 x 4 (40x100)		14
15		Length (STD)	in (mm)	42.1 (1070)		42.1 (1070)		42.1 (1070)		15
16	Tilt Angle	Standard mast - fwd/back	degree	5 / 10		5 / 10		5 / 10		16
17	Overall Dimensions	Length (to face of forks)	in (mm)	84.8 (2155)		86.2 (2190)		90.7 (2305)		17
18		Width (standard tires)	in (mm)	42.1 (1070)		42.1 (1070)		42.1 (1070)		18
19		Height - top of OHG	in (mm)	87.4 (2220)		87.4 (2220)		87.4 (2220)		19
20		Height - top of standard LBR	in (mm)	48.0 (1220)		48.0 (1220)		48.0 (1220)		20
21		Width - standard carriage	in (mm)	36.2 (920)		36.2 (920)		36.2 (920)		21
22	Grade Clearance	Ramp breakover angle	%	31.0		31.0		27.0		22
23		Departure angle	%	35.0		33.0		31.0		23
24	Overhang	Front	in (mm)	16.7 (425)		16.7 (425)		16.7 (425)		24
25		Rear	in (mm)	18.5 (470)		19.9 (505)		20.5 (520)		25
26	Turning Radius	Minimum outside	in (mm)	72.6 (1845)		73.8 (1875)		78.9 (2005)		26
27	Min Right Angle Stack	Add load length & clearance	in (mm)	89.3 (2270)		90.5 (2300)		95.6 (2430)		27
28	Speeds Maximum	Travel - loaded (36v / 48v)	mph (km/h)	10.3 (16.5)	10.3 (16.5)	9.3 (15.0)	9.3 (15.0)	9.3 (15.0)	9.3 (15.0)	28
29		Travel - unloaded (36v / 48v)	mph (km/h)	10.6 (17.0)	10.6 (17.0)	10.6 (17.0)	10.6 (17.0)	10.6 (17.0)	10.6 (17.0)	29
30		Lift - loaded (36v / 48v)	fpm (mm/sec)	69.0(350)	75.8(385)	63.0(320)	67.9(345)	63.0(320)	67.9(345)	30
31		Lift - unloaded (36v / 48v)	fpm (mm/sec)	108.3(550)	119.1(605)	108.3(550)	119.1(605)	108.3(550)	119.1(605)	31
32		Lowering - loaded	fpm (mm/sec)	98.5 (500)		98.5 (500)		98.5 (500)		32
33		Lowering - unloaded	fpm (mm/sec)	97.5 (495)		97.5 (495)		97.5 (495)		33
34	Drawbar Pull Maximum	Full load (36v/48v)	lb (N)	3410(15170)	3482(15490)	3410(15170)	3482(15490)	3410(15170)	3482(15490)	34
35	Gradeability Maximum	Full load (36v/48v)	%	23.5	24.0	20.0	20.5	20.0	20.5	35
37	Truck Weight	Empty, min. battery	lb (kg)	8090 (3670)		8950 (4060)		8820 (4000)		37
38	Weight Distribution	Full load front/rear - min. battery	lb (kg)	10515 / 1575 (4770 / 715)		12110 / 1840 (5495 / 835)		12100 / 1720 (5490 / 780)		38
39		No load front/rear - min. battery	lb (kg)	3230 / 4860 (1465 / 2205)		3000 / 5950 (1360 / 2700)		3295 / 5525 (1495 / 2505)		39
40	Tire Size	Front	in	21 x 7 x 15		21 x 7 x 15		21 x 7 x 15		40
41		Rear	in	16-1/4 x 6 x 11-1/4		16-1/4 x 6 x 11-1/4		16-1/4 x 6 x 11-1/4		41
42	Wheelbase		in (mm)	49.6 (1260)		49.6 (1260)		53.5 (1360)		42
43	Tread - Center of Tire	Front / rear (standard tires)	in (mm)	35.0 / 35.0 (890 / 890)		35.0 / 35.0 (890 / 890)		35.0 / 35.0 (890 / 890)		43
44	Headroom	SIP to bottom of OHG	in (mm)	42.3 (1075)		42.3 (1075)		42.3 (1075)		44
45	Counterweight Height		in (mm)	43.5 (1105)		43.5 (1105)		43.5 (1105)		45
46	Step Height		in (mm)	18.5 (470)		18.5 (470)		18.5 (470)		46
47	Ground Clearance	Under mast	in (mm)	3.1 (80)		3.1 (80)		3.1 (80)		47
48		Under power unit	in (mm)	3.9 (100)		3.9 (100)		3.9 (100)		48
49		Under frame, center of wheelbase	in (mm)	3.7 (95)		3.7 (95)		3.7 (95)		49
50	Service Brake	Type		Hyd / Elec		Hyd / Elec		Hyd / Elec		50
51	Parking Brake	Type		Pedal		Pedal		Pedal		51
52	Steering	On-demand		Hydraulic		Hydraulic		Hydraulic		52
53	Traction Motor	Type		AC Induction		AC Induction		AC Induction		53
54		Control type		MOS-INV		MOS-INV		MOS-INV		54
55		Rating	kW/h	9.0	12.0	9.0	12.0	9.0	12.0	55
56	Pump Motor	Type		AC Induction		AC Induction		AC Induction		56
57		Rating	kW/5min	12.8	13.7	12.8	13.7	12.8	13.7	57
58	Required Battery Size	Minimum - W x L	in (mm)	37.62 x 22.06 (955 x 560)		37.62 x 22.06 (955 x 560)		37.62 x 28.56 (955 x 725)		58
59		Minimum - H	in (mm)	21.37 (542)		21.37 (542)		21.37 (542)		59
60		Maximum - W x L	in (mm)	39.06 x 28.25 (992 x 717)		39.06 x 28.25 (992 x 717)		39.06 x 34.12 (992 x 866)		60
61		Maximum - H	in (mm)	22.81 (579)		22.81 (579)		22.81 (579)		61
62		Lead acid (36v / 48v)	Type	18-95-23	24-95-17	18-95-23	24-95-17	18-95-29	24-95-21	62
63		Capacity - Minimum (36v / 48v)	Ah/6h	825	600	825	600	1050	750	63
64		Capacity - Maximum (36v / 48v)	Ah/6h	1100	800	1100	800	1400	1000	64
65	Weight	Minimum / Maximum	lb (kg)	2491 / 3064 (1130 / 1390)		2491 / 3064 (1130 / 1390)		3075 / 3527 (1395 / 1600)		65
66	Lead Length	Position B	in (mm)	18 (455)		18 (455)		18 (455)		66
67	Connector		Type	SB-350 Gray		SB-350 Gray		SB-350 Gray		67

Platinum BX_{series}

Dimensions

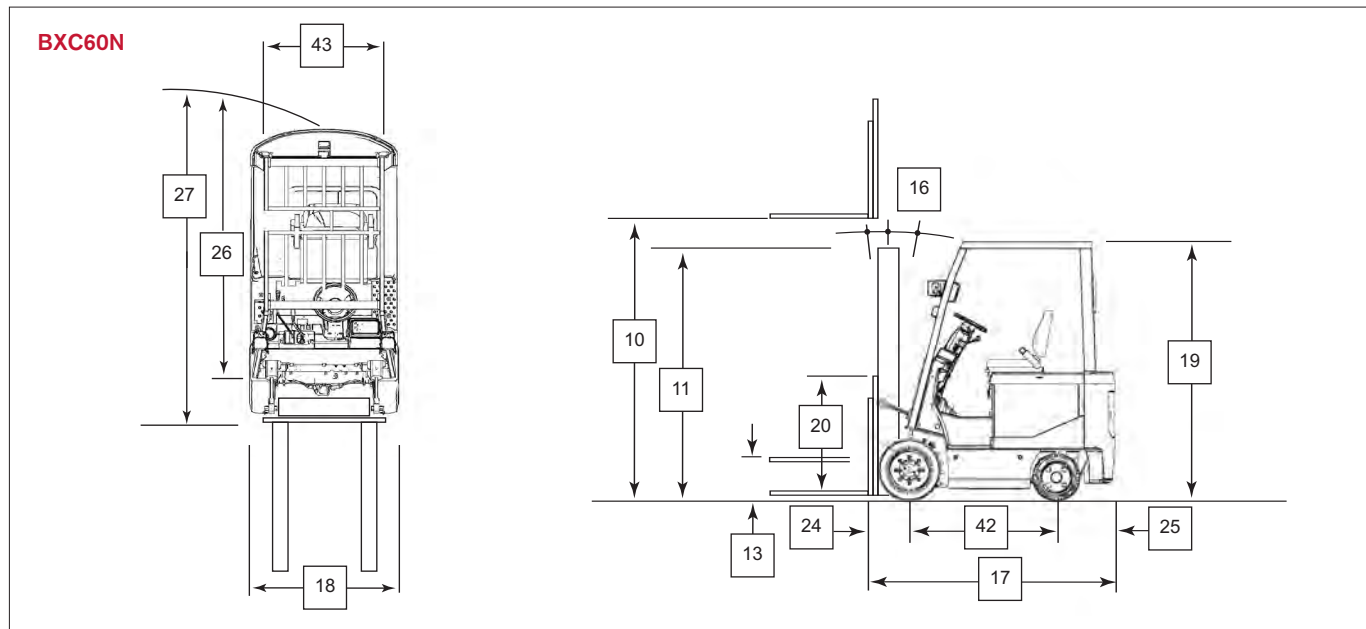

Mast Specifications & Rated Capacities

BXC60N	Mast Name	Maximum Fork Height	Overall Height Lowered	Free Lift*	Tilt angle Forward/Backward	Rated Capacity at 24" Load Center BXC60N
TWO STAGE (Wide view 2W)	2H270	106	71.3	7.1	5/10	6000
	2H300	118	77.2	7.1	5/10	6000
	2H330	130	83.1	7.1	5/10	6000
	2H350	138	88.4	7.1	5/10	6000
	2H370	146	93.3	10.6	5/10	6000
	2H400	157	100.8	10.6	5/10	6000
	2H450	177	110.6	10.6	5/5	5750
	2H500	197	120.5	10.6	5/5	5500
TWO STAGE (Full free 2F)	2F300	118	77.2	53.0	5/10	6000
	2F330	130	83.1	58.9	5/10	6000
	2F350	138	88.4	64.2	5/10	6000
	2F370	146	93.3	69.1	5/10	6000
	2F400	157	100.8	76.6	5/10	6000
THREE STAGE (Full free 3F)	3F385	152	77.2	53.0	5/5	6000
	3F430	169	83.1	58.9	5/5	5700
	3F475	187	88.4	64.2	5/5	5550
	3F515	203	93.3	69.1	5/5	5200
	3F550	217	100.8	76.6	5/5	4850
	3F600	236	110.6	86.4	5/5	3300
THREE STAGE (Optview 3V)	3V385	152	77.2	53.0	5/5	5650
	3V430	169	83.1	58.9	5/5	5450
	3V470	185	88.4	64.2	5/5	5300
	3V505	199	93.3	69.1	5/5	5000
	3V555	219	100.8	76.6	5/5	4500

* Without backrest

6,000 lb. capacity

Main Truck Specifications

CHARACTERISTICS	1	Manufacturer's Name		Nissan Forklift		1		
	2	Model	Model designation	BXC60N		2		
	3		Long model code	MCTG1B2L30S		3		
	4	Rated Load Capacity		lb (kg)	6000 (3000)		4	
	5	Load Center	Distance	in (mm)	24 (500)		5	
	6	Power Type	Electric	voltage	36v	48v	6	
	7	Operator Orientation			Sit		7	
DIMENSIONS	8	Tire Type	Front & rear	Cushion		8		
	9	Wheels	Number - front/rear (x=driven)	2x / 2		9		
	10	Mast	Maximum fork height	in (mm)	130 (3300)		10	
	11		Mast lowered (OHL)	in (mm)	83.1 (2111)		11	
	12		Mast extended with LBR	in (mm)	179.3 (4555)		12	
	13		Standard freelif	in (mm)	7.1 (180)		13	
	14	Forks	Thickness & width	in (mm)	2 x 5 (50x125)		14	
	15		Length (STD)	in (mm)	42.1 (1070)		15	
	16		Tilt Angle	Standard mast - fwd/back	degree	5 / 10		16
	17	Overall Dimensions	Length (to face of forks)	in (mm)	94.1 (2390)		17	
	18		Width (standard tires)	in (mm)	43.3 (1100)		18	
	19		Height - top of OHG	in (mm)	87.4 (2220)		19	
	20		Height - top of standard LBR	in (mm)	48.0 (1220)		20	
	21		Width - standard carriage	in (mm)	40.2 (1020)		21	
	22	Grade Clearance	Ramp breakover angle	%	27.0		22	
	23		Departure angle	%	28.0		23	
	24	Overhang	Front	in (mm)	17.7 (450)		24	
	25		Rear	in (mm)	22.8 (580)		25	
	26	Turning Radius	Minimum outside	in (mm)	81.1 (2060)		26	
	27	Min Right Angle Stack	Add load length & clearance	in (mm)	98.8 (2510)		27	
	PERFORMANCE	28	Speeds Maximum	Travel - loaded (36v / 48v)	mph (km/h)	8.1 (13.0)	8.7 (14.0)	28
		29		Travel - unloaded (36v / 48v)	mph (km/h)	9.3 (15.0)	9.3 (15.0)	29
		30		Lift - loaded (36v / 48v)	fpm (mm/sec)	50.2 (255)	55.1 (280)	30
		31		Lift - unloaded (36v / 48v)	fpm (mm/sec)	92.5 (470)	101.4 (515)	31
		32		Lowering - loaded	fpm (mm/sec)	98.5 (500)		32
		33		Lowering - unloaded	fpm (mm/sec)	97.5 (495)		33
		34		Drawbar Pull Maximum	Full load (36v/48v)	lb (N)	3924 (17455)	4007 (17825)
35	Gradeability Maximum	Full load (36v/48v)	%	19.5	20.0	35		
WEIGHT	37	Truck Weight	Empty, min. battery	lb (kg)	10550 (4785)		37	
	38	Weight Distribution	Full load front/rear - min. battery	lb (kg)	14345 / 2205 (6505 / 1000)		38	
	39		No load front/rear - min. battery	lb (kg)	3660 / 6890 (1660 / 3125)		39	
CHASSIS & WHEELS	40	Tire Size	Front	in	22 x 8 x 16		40	
	41		Rear	in	16-1/4 x 6 x 11-1/4		41	
	42	Wheelbase		in (mm)	53.5 (1360)		42	
	43	Tread - Center of Tire	Front / rear (standard tires)	in (mm)	35.2 / 35.0 (895 / 890)		43	
	44	Headroom	SIP to bottom of OHG	in (mm)	42.3 (1075)		44	
	45	Counterweight Height		in (mm)	43.5 (1105)		45	
	46	Step Height		in (mm)	18.5 (470)		46	
	47	Ground Clearance	Under mast	in (mm)	3.1 (80)		47	
	48		Under power unit	in (mm)	3.7 (95)		48	
	49		Under frame, center of wheelbase	in (mm)	3.5 (90)		49	
	50	Service Brake	Type		Hyd / Elec		50	
51	Parking Brake	Type		Pedal		51		
DRIVE LINE	52	Steering	On-demand	Hydraulic		52		
	53	Traction Motor	Type	AC Induction		53		
	54		Control type	MOS-INV		54		
	55		Rating	kW/h	9.0	12.0	55	
	56	Pump Motor	Type	AC Induction		56		
57	Rating		kW/5min	12.8	13.7	57		
BATTERY	58	Required Battery Size	Minimum - W x L	in (mm)	37.62 x 28.56 (955 x 725)		58	
	59		Minimum - H	in (mm)	21.37 (542)		59	
	60		Maximum - W x L	in (mm)	39.06 x 34.12 (992 x 866)		60	
	61		Maximum - H	in (mm)	22.81 (579)		61	
	62		Lead acid (36v / 48v)	Type	18-95-29	24-95-21	62	
	63		Capacity - Minimum (36v / 48v)	Ah/6h	1050	750	63	
	64		Capacity - Maximum (36v / 48v)	Ah/6h	1400	1000	64	
65	Weight	Minimum / Maximum	lb (kg)	3075 / 3527 (1395 / 1600)		65		
66	Lead Length	Position B	in (mm)	18 (455)		66		
67	Connector		Type	SB-350 Gray		67		

Platinum BX_{series}

Dimensions

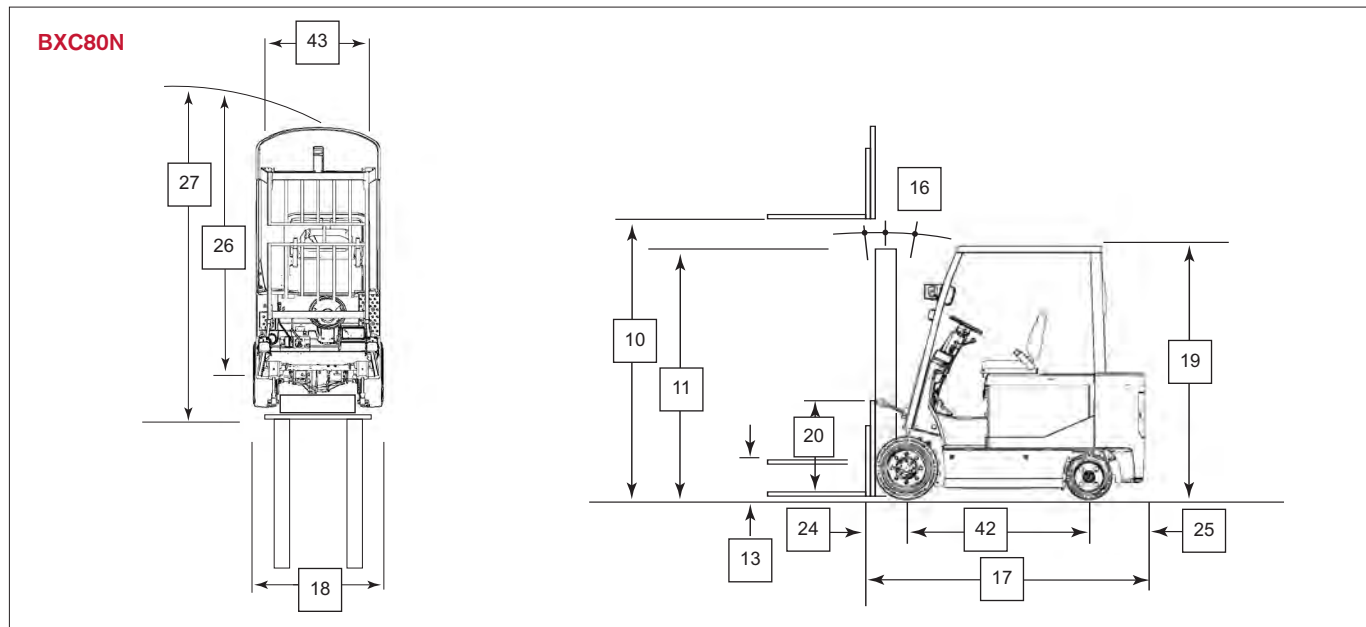

Mast Specifications & Rated Capacities

BXC80N	Mast Name	Maximum Fork Height	Overall Height Lowered	Free Lift*	Tilt angle Forward/Backward	Rated Capacity at 24" Load Center BXC80N
TWO STAGE (Wide view 2W)	2H280	110	77.2	7.1	5/10	8000
	2H310	122	83.1	7.1	5/10	8000
	2H350	138	93.3	10.6	5/10	8000
	2H380	150	100.8	10.6	5/10	8000
	2H430	169	110.6	10.6	5/10	8000
TWO STAGE (Full free 2F)	2F280	110	77.2	51.0	5/10	8000
	2F310	122	83.1	56.9	5/10	8000
	2F350	138	93.3	67.1	5/10	8000
	2F380	150	100.8	74.6	5/10	8000
THREE STAGE (Full free 3F)	3F400	157	77.2	51.0	5/5	8000
	3F445	175	83.1	56.9	5/5	7700
	3F485	191	88.4	62.2	5/5	7550
	3F520	205	93.3	67.1	5/5	7200
	3F570	224	100.8	74.6	5/5	6850
THREE STAGE (Optview 3V)	3V385	152	77.2	52.2	5/5	7650
	3V430	169	83.1	58.1	5/5	7450
	3V470	185	88.4	63.4	5/5	7300
	3V505	199	93.3	68.3	5/5	7000
	3V555	219	100.8	75.8	5/5	6500

* Without backrest

8,000 lb. capacity

Main Truck Specifications

CHARACTERISTICS				Nissan Forklift			
1	Manufacturer's Name			Nissan Forklift		1	
2	Model	Model designation		BXC80N		2	
3		Long model code		MCTG1B2L35S		3	
4	Rated Load Capacity		lb (kg)	8000 (4000)		4	
5	Load Center	Distance	in (mm)	24 (500)		5	
6	Power Type	Electric	voltage	36v	48v	6	
7	Operator Orientation			Sit		7	
DIMENSIONS							
8	Tire Type	Front & rear		Cushion		8	
9	Wheels	Number - front/rear (x=driven)		2x / 2		9	
10	Mast	Maximum fork height	in (mm)	138 (3500)		10	
11		Mast lowered (OHL)	in (mm)	93.3 (2370)		11	
12		Mast extended with LBR	in (mm)	187.2 (4755)		12	
13		Standard freelif	in (mm)	10.6 (270)		13	
14	Forks	Thickness & width	in (mm)	2 x 5 (50x125)		14	
15		Length (STD)	in (mm)	42.1 (1070)		15	
16	Tilt Angle	Standard mast - fwd/back	degree	5 / 10		16	
17	Overall Dimensions	Length (to face of forks)	in (mm)	100.2 (2545)		17	
18		Width (standard tires)	in (mm)	43.3 (1100)		18	
19		Height - top of OHG	in (mm)	87.4 (2220)		19	
20		Height - top of standard LBR	in (mm)	48.0 (1220)		20	
21		Width - standard carriage	in (mm)	40.2 (1020)		21	
22	Grade Clearance	Ramp breakover angle	%	23.0		22	
23		Departure angle	%	33.0		23	
24	Overhang	Front	in (mm)	17.9 (455)		24	
25		Rear	in (mm)	19.3 (490)		25	
26	Turning Radius	Minimum outside	in (mm)	88.4 (2245)		26	
27	Min Right Angle Stack	Add load length & clearance	in (mm)	106.3 (2700)		27	
PERFORMANCE							
28	Speeds Maximum	Travel - loaded (36v / 48v)	mph (km/h)	7.1 (11.5)	7.8 (12.5)	28	
29		Travel - unloaded (36v / 48v)	mph (km/h)	9.0 (14.5)	9.0 (14.5)	29	
30		Lift - loaded (36v / 48v)	fpm (mm/sec)	43.3 (220)	46.3 (235)	30	
31		Lift - unloaded (36v / 48v)	fpm (mm/sec)	77.8 (395)	84.7 (430)	31	
32		Lowering - loaded	fpm (mm/sec)	98.5 (500)		32	
33		Lowering - unloaded	fpm (mm/sec)	97.5 (495)		33	
34	Drawbar Pull Maximum	Full load (36v/48v)	lb (N)	3924 (17455)	4007 (17825)	34	
35	Gradeability Maximum	Full load (36v/48v)	%	16.5	16.5	35	
37	Truck Weight	Empty, min. battery	lb (kg)	12380 (5615)		37	
38	Weight Distribution	Full load front/rear - min. battery	lb (kg)	18000 / 2380 (8165 / 1080)		38	
39		No load front/rear - min. battery	lb (kg)	4675 / 7705 (2120 / 3495)		39	
40	Tire Size	Front	in	22 x 8 x 16		40	
41		Rear	in	16-1/4 x 6 x 11-1/4		41	
42	Wheelbase		in (mm)	63.0 (1600)		42	
43	Tread - Center of Tire	Front / rear (standard tires)	in (mm)	35.2 / 35.0 (895 / 890)		43	
44	Headroom	SIP to bottom of OHG	in (mm)	42.3 (1075)		44	
45	Counterweight Height		in (mm)	43.5 (1105)		45	
46	Step Height		in (mm)	18.5 (470)		46	
47	Ground Clearance	Under mast	in (mm)	3.1 (80)		47	
48		Under power unit	in (mm)	3.7 (95)		48	
49		Under frame, center of wheelbase	in (mm)	3.5 (90)		49	
50	Service Brake	Type		Hyd / Elec		50	
51	Parking Brake	Type		Pedal		51	
52	Steering	On-demand		Hydraulic		52	
DRIVE LINE							
53	Traction Motor	Type		AC Induction		53	
54		Control type		MOS-INV		54	
55		Rating	kW/h	9.0	12.0		55
56	Pump Motor	Type		AC Induction		56	
57		Rating	kW/5min	12.8	13.7		57
BATTERY							
58	Required Battery Size	Minimum - W x L	in (mm)	37.62 x 28.56 (955 x 725)		58	
59		Minimum - H	in (mm)	21.37 (542)		59	
60		Maximum - W x L	in (mm)	39.06 x 34.12 (992 x 866)		60	
61		Maximum - H	in (mm)	22.81 (579)		61	
62		Lead acid (36v / 48v)	Type	18-95-29	24-95-21	62	
63		Capacity - Minimum (36v / 48v)	Ah/6h	1200	1000		63
64		Capacity - Maximum (36v / 48v)	Ah/6h	1400	1200		64
65		Weight	Minimum / Maximum	lb (kg)	3351 / 3527 (1520 / 1600)		65
66	Lead Length	Position B	in (mm)	18 (455)		66	
67	Connector	Type		SB-350 Gray		67	

* 2W330 mast, less forks

Platinum BX Cushion Series

Technical Information

Standard Equipment

1. 36/48-Volt, brushless AC drive, motor, lift and steering systems
2. Nissan Forklift's AC TECH controller with built-in test equipment and multifunction LCD display
3. Multi-function LCD display with:
 - BDI with lift interrupt
 - Hour meters (4)
 - Speedometer
 - Clock
4. On-board diagnostics, self-test and coded service history
5. Three pre-set performance modes—economy, normal and high performance settings, plus a manual setting.
6. Secure, PIN access to personalized performance settings
7. Load sensing on-demand AC controlled hydraulic power steering
8. Flex-logic acceleration control
9. Five-mode regenerative braking
10. Nissan Forklift's Operator Presence System includes seat-actuated power interrupt system, seat belt warning buzzer and parking brake warning buzzer
11. Audible back-up warning alarm
12. Controlled rollback feature restricts truck descent speed down an incline
13. AC-powered hydraulic pump motor and drive motor
14. Full suspension, fold down cloth seat with operator restraint system and locking retractor seat belt
15. Infinitely adjustable steering column
16. Small diameter steering wheel

17. Overhead guard mounted headlights
18. Five-piece reinforced overhead guard
19. Cushioned stability control
20. Auto-Power off
21. Foot operated parking brake
22. Exclusive single lift and tilt control lever provides greater opportunity for increased productivity
23. U.L. "ES" rated electrical system

Optional Equipment

1. Nissan Forklift's exclusive three-stage OPTIVIEW® mast with 50% greater visibility
2. Standard, or polished and tapered, forks in a variety of lengths
3. Side shifters with auxiliary hydraulics, valving, and levers
4. Single, or dual, IHR for all mast types
5. Separate lift/tilt control levers
6. Auto tilt leveling
7. Hydraulic accumulator in the lift system
8. Traction, or smooth, non-marking tires
9. Strobe light
10. Fire extinguisher
11. Magnetic convenience tray
12. Freezer package for environments as low as -31°F (-35°C)
13. Battery compartment rollers
14. Rearview mirrors
15. Steering wheel spinner knob
16. Turn, stop and backup lights
17. Rear work light
18. U.L. "EE" rated electrical system

19. Overhead guard modified for drive-in racking
20. Higher and lower overhead guard settings

Ergonomics and Operator Comfort

The Platinum BX Series offers a variety of operator conveniences for enhanced comfort and increased productivity, including a full suspension cloth seat with weight and back-angle adjustment, hip restraint and retractable seat belt. A compact front cowl design offers generous leg and foot room along with a wide entry step. Its infinitely adjustable steering column enhances operator comfort.

The Platinum BX Series' AC TECH controller offers Flex-logic acceleration control which enables the truck to respond according to the speed with which the pedal is depressed, allowing more accurate, precise control by the driver. The hydraulic, AC powered, steering system reduces operator effort, for easier maneuvering, while a hydraulic load sensing valve diverts fluid for priority to the steering system.

The standard, Nissan Forklift exclusive, single lift/tilt control lever design offers enhanced ergonomics and improved productivity. Separate lift and tilt hydraulic control levers are optional.

The LCD dash display visibly communicates truck status and warnings for operator awareness including: travel speed, battery capacity, hour meter (4-mode), time and day of week, brake warning, seat belt warning, and selected power mode.

Technical Information 4-wheel AC-powered models

Technical Information

The Platinum BX Series' Safety System includes: Mast Lock (automatically locking mast lift and tilt when the operator leaves the seat), Cushioned Stability Control (incorporates a maintenance-free rubber damper between the rear axle and body to enhance lateral stability under normal driving conditions), and Controlled Rollback (reducing quick truck movement down a gradient, when the accelerator is released).

Efficient Performance

The Platinum BX Series' AC TECH controller provides lower battery consumption and optimum operating efficiencies through regenerative braking, automatic deceleration, and on-demand power steering. Five-mode regenerative braking system increases the number of working hours per battery charge. An adjustable auto-power off feature will switch off the electrical system if the truck sits idle for a predetermined time period.

A four-digit PIN code offers access to adjustable performance settings, allowing up to five unique operational profiles according to driver experience and load handling conditions. Or, select from three preset performance modes (economy, normal, high) based on the application. If additional flexibility is needed you can manually adjust settings to meet application needs.

Battery and Electrical

Available with an "ES" rated 36 or 48 volt electrical system. The AC TECH motor controller features MOS-FET power inverters for DC to three phase AC power conversion. Single contactor design reduces maintenance.

Truck and Mast Design

The Platinum BX Series' rugged, unitized frame design incorporates an integral hydraulic tank for better heat dissipation, increased durability, and longer life. Contoured counterweight design enhances maneuverability.

Five-piece reinforced overhead guard design allows easy replacement should individual parts become damaged. Slotted design facilitates overhead battery replacement.

Our flat face mast design features rolled steel channels, large cross sections, and thick inner rails for increased capacity retention. Side thrust rollers on the fork carriage are easily accessed for carriage adjustment. Optional Nissan Forklift's exclusive OPTIVIEW, three-stage mast design offers 50% greater visibility for improved load handling.

Drive Unit

Free floating drive axle with lateral mounted AC drive motor offers more power and quicker response. Quieter, more efficient helical gearing reduces noise levels and increases durability. Service brakes are standard shoe type.

Hydraulics

Powerful AC hydraulic pump motor powers lift and tilt operation as well as the on-demand power steering system. Hydraulic operation is infinitely variable through the AC TECH controller.

Brake System

Regenerative braking is achieved through switch-back/plugging, foot applied braking, neutral braking, controlled roll back and lift lever stopping. Reduced height brake pedal improves the ease of operation and reduces operator fatigue. Automatic, programmable

deceleration prolongs battery life. An automotive feel and lower operating force are realized by a foot-actuated parking brake, with lock release button located on the cowl within easy reach.

Ease of Maintenance

The Platinum BX Series features a 100% AC-powered system, including brushless drive motor and hydraulic pump motor. On-demand steering achieved through priority hydraulic load sensing valve, eliminating use of a separate steering motor. The design greatly reduces the number of serviceable parts, including commutators, contactors, and brushes; eliminating expenses related to inspection and replacement of these items, for lower overall operating costs.

The AC TECH controller includes a built-in-test-equipment module with self-diagnostics and coded service history, logged by hour meter reading. Troubleshooting through the instrument panel allows rapid access to service requirements. No additional handset tool is required. Hydraulic oil tank filler location makes daily level checks and periodic refills fast and simple.

Option Availability

Platinum BX Series - Option Availability

Standard S Option O

Vehicle Management	On-board self-diagnostics	S
	Self-check system	S
	3+1 performance modes (Economy, Performance, High Performance, Manual)	S
	Security PIN access	S
Powertrain	UL "ES" safety rating*	S
	AC TECH inverter motor control	S
	Flex-logic acceleration control	S
Brake	5-mode regenerative braking	S
	Automatic programmable deceleration	S
	Foot applied parking brake with warning alarm	S
Mast	Auto mast lock	S
	OPTIVIEW three-stage mast*	O
Hydraulic System	Precise AC TECH controlled hydraulics	S
	Hydraulic load sensing valve system	S
	Single lift/tilt control lever	S
	Separate lift and tilt control levers	O
	Auto-tilt leveling function	O
Steering System	On-demand hydrostatic power steering	S
	Small diameter steering wheel	S
	Spinner knob	O
Operator Conveniences	OHG-mounted headlights	S
	Rear combination lights	O
	Rear work light	O
	Warning alarms: back-up, seat belt and parking brake	S
	Multi-function LCD meter panel	S
	Higher/lower overhead guard heights*	O
Battery	Battery compartment rollers*	O
Freezer Package	-31°F (-35°C) protection*	O

*Available on BX Series cushion models only. Optional U.L. "EE" rating is available on cushion models only.



SS-BXCN 02-12
Printed in U.S.A.

www.nissanforklift.com



NISSAN
GREEN PROGRAM



Scan for more information

Nissan Forklift, Platinum, OPTIVIEW, Nomad, and the Nissan Forklift logo are all registered trademarks of Nissan Forklift Corporation, North America. Nissan Forklift Corporation reserves the right to make product changes relating to colors, equipment, specifications or available options without notice. For more information, contact your Nissan Forklift representative.

NISSAN
FORKLIFT

